

LABOR AND MATERIALS

3/4 Copper	} Connection		\$	
Lead				
Curb	} Cock Valve T. S. & V.	in.	\$	
Service box		} Short 3 1/2 x 4 1/2 Long 4 1/2 x 5 1/2		
Old returned				\$
8' 4" 3/4 Ft.	} Copper <del>G.I.</del> <del>G.I.</del>	Pipe at	\$	
Nipples		in. at	\$	
Bushings		to in. at	\$	
Red'g Inc'g	} Coupl'gs.	to in. at	\$	
Union		in. at	\$	
Meter	in. at	\$		
			\$	
Compound Joints	at		\$	
Maintenance Foreman			\$	
Hrs. Water Maint. Man—1	at		\$	
Hrs. Water Maint. Man—2	at		\$	
Hrs. Garage Foreman	at		\$	
Hrs. Labor—	at		\$	
Hrs. Compressor	at		\$	
			\$	
Trucking			\$	
Pav't Patch			\$	
			\$	
			\$	
			\$	
			\$	

ok  
17 Arlington St. Pl. Ave. No. 17

Name of Owner  
Camp

Labor and Mat'l. Report 8-29-1995

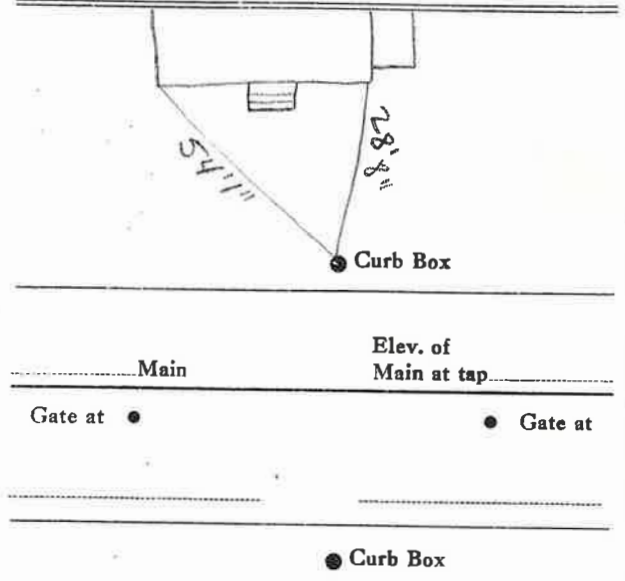

Main Elev. of Main at tap  
Gate at ● Gate at ●

● Curb Box