

LABOR AND MATERIALS

/	Copper	Connection	3/4"		\$
	Lead				
/	Curb	Cock Valve T. S. & V.	3/4 in.		\$
/	Service Box	Short 3/2x4 1/2			\$
	Old returned	Long 4/2x5 1/2			
		Buff. or Rdway			
10	Ft	3/4 in.		Copper Galv. Iron Cast Iron	Pipe at \$
	Nipples	in. at			\$
	Bushings	to in. at			\$
	Red'g Inc'g	Couplings to in. at			\$
	Union	in. at			\$
	Meter	in. at			\$
	Lead Joints	at			\$
	Leadite Joints	at			\$
	Hrs. Foreman	at			\$
	Hrs. Chauffeur	at			\$
	Hrs. Tapper	at			\$
	Hrs. Labor	at			\$
	Hrs. Labor	at			\$
	Hrs. Compressor	at			\$
	Compensation Ins.				\$
	Trucking				\$
	Builders Use of Water				\$
	Tap by Gifford & Co. 7-25-58				\$
					\$
					\$
					\$

St. #111111
 Pl. #111111
 Ave. No. 7

Name of Owner _____

Labor and Mat'l. Report July 25 1958

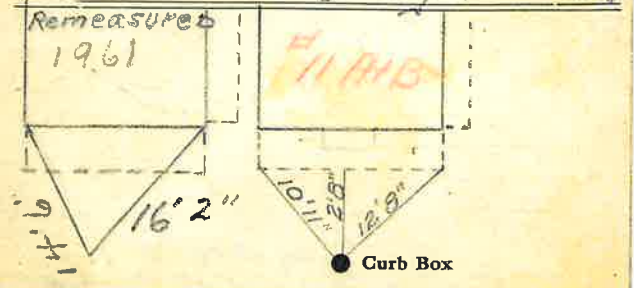

c.l.
 6" Main 1958 Elev. of Main at tap 5 1/2'

Gate at ● ● Gate at

● Curb Box

Phil Rose
do not bill per Homer.
 1/16/57

LABOR AND MATERIALS

1	Copper Lead	} Connection	$\frac{3}{4}$		\$ _____
1	Curb	} Cook Valve T.S. & V.	$\frac{3}{4}$ in.		\$ _____
1	Service box Old returned	} Short $3\frac{1}{2} \times 4\frac{1}{2}$ Long $4\frac{1}{2} \times 5\frac{1}{2}$ Buff or Rdway			\$ _____
12	Ft. $\frac{3}{4}$ in.	} Copper G.I. C.I.	} Pipe at		\$ _____
	Nipples	in. at			\$ _____
	Bushings	to in. at			\$ _____
	Red'g Inc'g	} Coupl'gs	to in. at		\$ _____
	Union	in. at			\$ _____
	Meter	in. at			\$ _____
	Lead Joints	at			\$ _____
	Compound Joints	at			\$ _____
	Maintenance Foreman				\$ _____
	Hrs. Water Maint. Man	—1 at			\$ _____
	Hrs. Water Maint. Man	—2 at			\$ _____
	Hrs. Garage Foreman	at			\$ _____
	Hrs. Labor	at			\$ _____
	Hrs. Compressor	at			\$ _____
	Compensation Ins.	at \$ _____ per C			\$ _____
	Trucking				\$ _____
	Pav't Patch				\$ _____
					\$ _____
					\$ _____
	O'head				\$ _____
					\$ _____

AUBURN St. Pl. Ave. No. 7

Name of Owner _____

Labor and Mat'l. Report 19

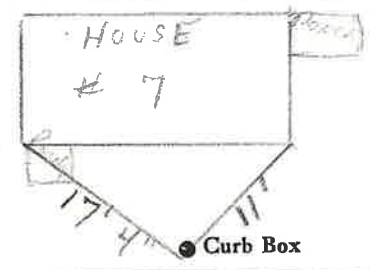

6" Main Elev. of Main at tap 5'

Gate at • • Gate at

• Curb Box