

South West

Corner Aviation St.
West Mountain Rd. Pl. Ave. No.

Name of Owner
John Parker

Labor and Mat'l. Report Oct. 29 1970

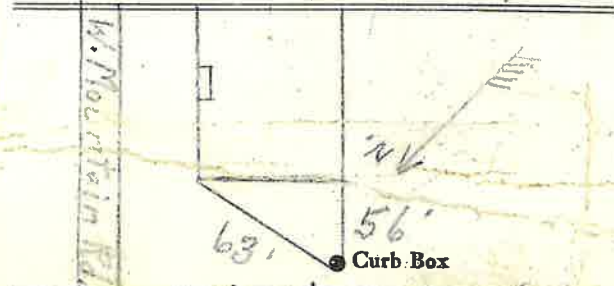

12" Main Elev. of Main at tap 3 1/2' - to main

Gate at 4' to Top of Corp. Gate at

● Curb Box
Tap on 12" Wilkie main. Tap on side of main with 45° Bend.

LABOR AND MATERIALS

1	Copper Lead	Connection	3/4" - 45° Bend	\$
1	Curb	Cock Valve T.S. & V.	3/4" in. Oriseal	\$
1	Service box	Short 3 1/2 x 4 1/2		\$
	Old returned	Long 4 1/2 x 5 1/2		\$
		Buff or Rdway		\$
22	Ft. 3/4 in.	Copper G.I. C.I.	Pipe at	\$
	Nipples	in. at		\$
	Bushings	to in. at		\$
	Red'g Inc'g	Coupl'gs. to in. at		\$
	Union	in. at		\$
	Meter	in. at		\$
	Lead Joints	at		\$
	Compound Joints	at		\$
	Maintenance Foreman			\$
	Hrs. Water Maint. Man-1	at		\$
	Hrs. Water Maint. Man-2	at		\$
	Hrs. Garage Foreman	at		\$
	Hrs. Labor	at		\$
	Hrs. Compressor	at		\$
	Compensation Ins.	at \$ per C		\$
	Trucking			\$
	Pav't Patch			\$
	Tap by hand saw			\$
	Peckle	10-30-70		\$
	O'head			\$

Discor on 10/1/2001
Tony MISTA
CERT P.