

Iron Clad Portland Cement

VELO HIGH-EARLY - IRON CLAD MASONRY CEMENT

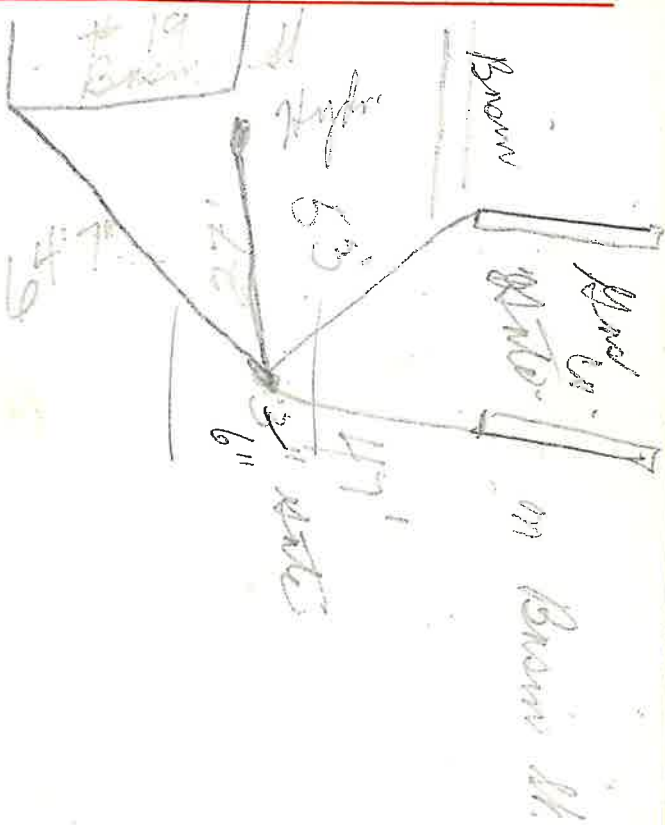

Labor and Material Report

19

Basin St
Valve for Gas plant
6"

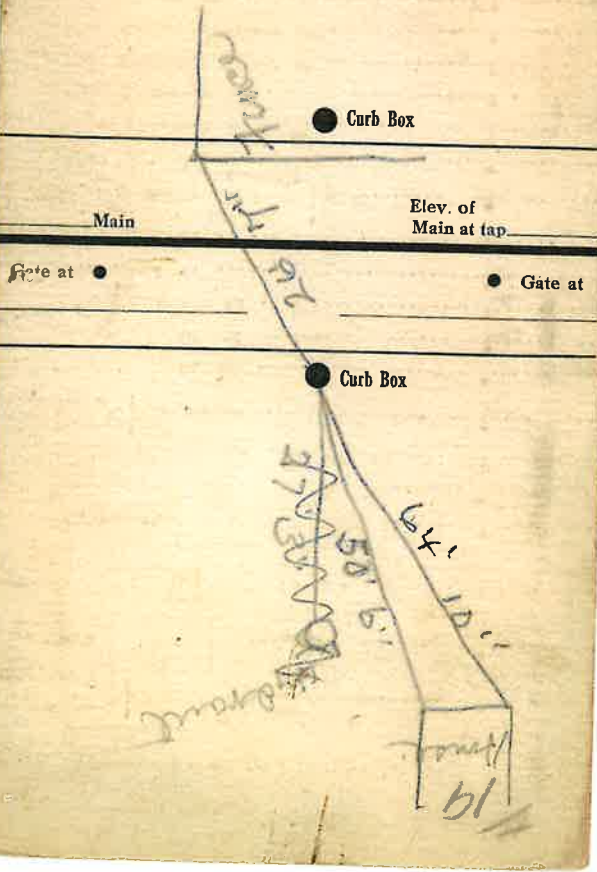

THE GLENS FALLS PORTLAND CEMENT CO.

GLENS FALLS, N. Y. A DIVISION OF THE FLINTKOTE COMPANY BOSTON, MASS.
Area Code 518 GLENS FALLS, N. Y. Area Code 617
RX 2-1137 LI-2-4634

Labor and Materials

Copper	Connection	\$
Lead		\$
Curb	Cook Valve T.S.&V. In	\$
	Short 3/4x4 1/2	\$
	Long 4 1/2x3 1/2	\$
	Old returned B.W. or Rd.wer	\$
	Service Box	\$
	Galv. Iron	\$
	Cast Iron	\$
	Pipe at	\$
	Nipples In. at	\$
	Bushings to	\$
	Red's Couplings to	\$
	Union In. at	\$
	Meter In. at	\$
	Lbs. Br. Stone	\$
	Lbs. Sand	\$
	Bags Cement	\$
	Paving Brick at	\$
	Lead Joints	\$
	Lead Joints	\$
	Lead Joints	\$
	Hrs. Foreman	\$
	Hrs. Common Labor	\$
	Hrs. Common Labor	\$
	Hrs. Mason	\$
	Hrs. Masons Helper	\$
	Hrs. Compressor	\$
	Compensation Ins	\$
	Trucking	\$
	Builders Use of Water	\$
	Total	\$	\$