

LABOR AND MATERIALS

1	Copper Lead	} Connection	3/4		\$
1	Curb	} Cock Valve T.S. & V.	} 3/4 in.		\$
1	Service box Old returned	{ Short 3 1/2 x 4 1/2 Long 4 1/2 x 5 1/2 Buff or Rdway			\$
33	Ft.	3/4 in. { Copper G.I. G.I.	} Pipe at		\$
	Nipples	in. at			\$
	Bushings	to in. at			\$
	Red'g Inc'g	Coupl'gs. to in. at			\$
	Union	in. at			\$
	Meter	in. at			\$
	Lead Joints	at			\$
	Compound Joints	at			\$
	Maintenance Foreman				\$
	Hrs. Water Maint. Man-1	at			\$
	Hrs. Water Maint. Man-2	at			\$
	Hrs. Garage Foreman	at			\$
	Hrs. Labor	at			\$
	Hrs. Compressor	at			\$
	Compensation Ins.	at \$ per C			\$
	Trucking				\$
	Pav't Patch				\$
					\$
					\$
					\$
	O'head				\$
					\$

TAID TAP
ON FULTON ST
BETWEEN #3 & #4

BAY

St.
Pl.
Ave. No. 89 1/2

Name of Owner

Labor and Mat'l. Report

19

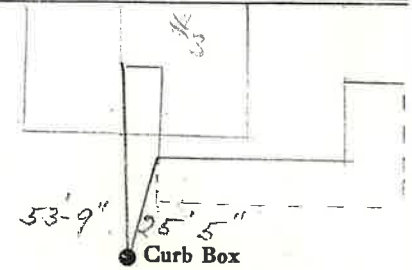

FULTON

10 Main

Elev. of
Main at tap 5

Gate at ●

● Gate at

OFF
11/24/06 BUT
NOT IN STREET

● Curb Box