

LABOR AND MATERIALS

1	Copper Lead	Connection	<u>3/4</u>		\$
1	Curb	Cock Valve T.S. & V.	<u>3/4</u> in.		\$
	Service box Old returned	Short $3\frac{1}{2} \times 4\frac{1}{2}$ Long $4\frac{1}{2} \times 5\frac{1}{2}$ Buff or Rdway			\$
34	Ft. <u>3/4</u> in.	Copper G.I. C.I.	Pipe at		\$
	Nipples	in. at			\$
	Bushings	to in. at			\$
	Red'g Inc'g	Coupl'gs to in. at			\$
	Union	in. at			\$
	Meter	in. at			\$
	Lead Joints at				\$
	Compound Joints at				\$
	Maintenance Foreman				\$
	Hrs. Water Maint. Man-1 at				\$
	Hrs. Water Maint. Man-2 at				\$
	Hrs. Garage Foreman at				\$
	Hrs. Labor at				\$
	Hrs. Compressor at				\$
	Compensation Ins. at \$	per C			\$
	Trucking				\$
	Pav't Patch				\$
					\$
					\$
	O'head				\$
					\$

St.
Pl.
Ave. No. 104

BAY

Name of Owner _____

TAX ID # 302.16-19-2.1

Labor and Mat'l. Report 19

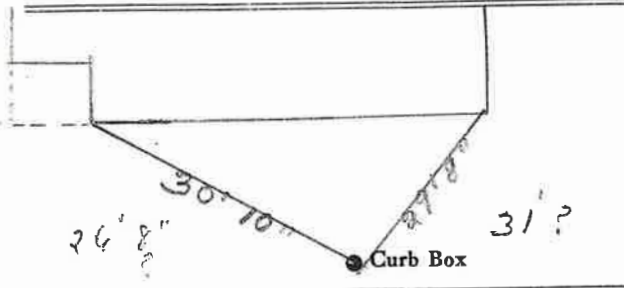

10 Main Elev. of Main at tap 5

Gate at ● ● Gate at

● Curb Box