

### LABOR AND MATERIALS

1	Copper Lead	} Connection	<u>1 1/2"</u>		\$		
1	Curb	} Cock Valve	<u>1 1/2 in.</u>		\$		
		T. S. & V.					
1	Service box	}	Short 3 1/2 x 4 1/2				
	Old returned		Long 4 1/2 x 5 1/2				
			Buff or Rdway		\$		
9	Ft. 1 1/2 in.	}	Copper	} Pipe at			
			G. I.			\$	
			G. I.				
	Nipples	in. at			\$		
	Bushings	to in. at			\$		
	Red'g Inc'g	} Coupl'gs	to in. at		\$		
	Union		in. at		\$		
	Meter	in. at			\$		
	Lead Joints	at			\$		
	Compound Joints	at			\$		
	Maintenance Foreman				\$		
	Hrs. Water Maint. Man-1	at			\$		
	Hrs. Water Maint. Man-2	at			\$		
	Hrs. Garage Foreman	at			\$		
	Hrs. Labor	at			\$		
	Hrs. Compressor	at			\$		
	Compensation Ins.	at \$	per C		\$		
	Trucking				\$		
	Pav't Patch				\$		
					\$		
					\$		
					\$		
	O'head				\$		
					\$		

St. PT  
Ave. No. 37

BAY

Name of Owner  
G. F. SAVING & LOAN ASSN.

Labor and Mat'l. Report 19 81

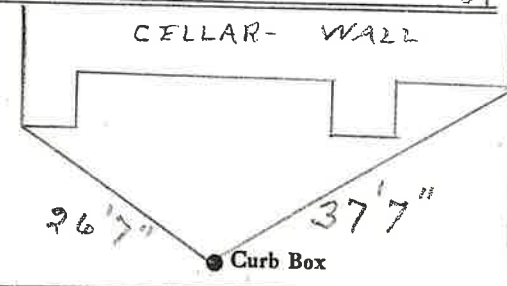

● Curb Box

10" Main Elev. of Main at tap 5 1/2'

Gate at ● ● Gate at

● Curb Box