

LABOR AND MATERIALS

1	Copper	} Connection $\frac{3}{4}$	\$	
	Lead			
1	Curb	} Cock Valve T.S. & V. } $\frac{3}{4}$ in.	\$	
1	Service box		{ Short $3\frac{1}{2} \times 4\frac{1}{2}$ Long $4\frac{1}{2} \times 5\frac{1}{2}$ Buff or Rdway }	\$
	Old returned			
35	Ft. $\frac{3}{4}$ in.	{ Copper G.I. G.I. } Pipe at	\$	
	Nipples	in. at	\$	
	Bushings	to in. at	\$	
	Red'g	} Coupl'gs to in. at	\$	
	Inc'g			
	Union	in. at	\$	
	Meter	in. at	\$	
	Lead Joints	at	\$	
	Compound Joints	at	\$	
	Maintenance Foreman		\$	
	Hrs. Water Maint. Man-1	at	\$	
	Hrs. Water Maint. Man-2	at	\$	
	Hrs. Garage Foreman	at	\$	
	Hrs. Labor	at	\$	
	Hrs. Compressor	at	\$	
	Compensation Ins. at \$	per C	\$	
	Trucking		\$	
	Pav't Patch		\$	
	O'head		\$	

BAY St. Pl. Ave. No. 126

Name of Owner

TAX ID # 302.16-17-25

Labor and Mat'l. Report

19

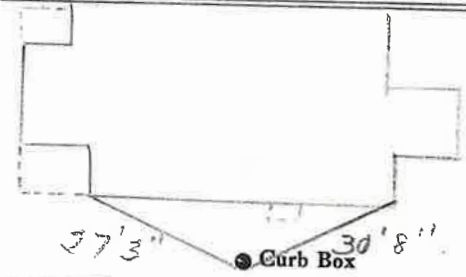

6 Main

Elev. of Main at tap 5 1/2

Gate at ●

● Gate at

● Curb Box