

LABOR AND MATERIALS

1	Copper	Connection	1"	\$
1	Lead	Cock	1 1/2"	\$
1	Curb	Valve		\$
		T.S. & V.		\$
1	Service box	Short 3/4 x 4 1/2		\$
	Old returned	Long 4 1/2 x 5 1/2		\$
		Half or Rdway		\$
37'-1"				
8	Ft. 1 1/2 in.	Copper	Pipe at	(TOTAL) \$ 45'
		G. I.		
		C. I.		
	Nipples	in. at		\$
	Bushings	to in. at		\$
	Red'g			\$
	Inc'g	Coupl'gs. to in. at		\$
	Union	in. at		\$
	Meter	in. at		\$
1	Lead Joints at	1" 3pc Coupling		\$
	Compound Joints at			\$
	Maintenance Foreman			\$
	Hrs. Water Maint. Man-1 at			\$
	Hrs. Water Maint. Man-2 at			\$
	Hrs. Garage Foreman at			\$
	Hrs. Labor at			\$
	Hrs. Compressor at			\$
	Compensation Ins. at \$	per C		\$
	Trucking			\$
	Pav't Patch			\$
	TAP MADE BY Beecher			\$
	TCO 8-15-1973			\$
	O'head			\$

COR. Bay + Washington

Bay

St. No. 54

Name of Owner

Methodist Christ Church

Labor and Mat'l. Report Aug 15 1973

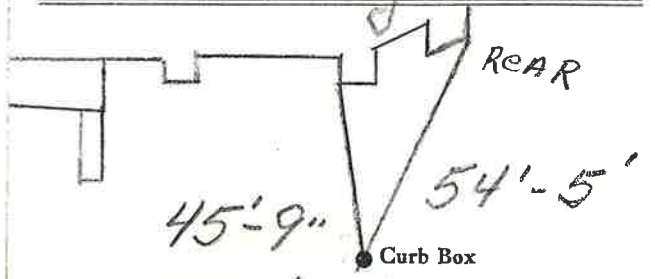

8" Main Elev. of Main at tap 5'

Gate at • Gate at

• Curb Box

LABOR AND MATERIALS

1 Copper } Connection 1 1/2" \$  
 Lead }  
 1 Curb } Cock Valve } 2 in. IRON TO IRON  
 T.P. & W. } ORISE #1  
 1 Service box } Short 3 1/2" x 4 1/2"  
 Old returned } Long 4 1/2" x 5 1/2"  
 Buff or Rdway } \$  
 45 Ft. 1 1/2 in. } Copper } Pipe at \$  
 G. I. }  
 C. I. }  
 Nipples in. at \$  
 Bushings to in. at \$  
 Red'g }  
 Inc'g } Coupl'gs to in. at \$  
 Union in. at \$  
 Meter in. at \$  
 2 Lead Joints at 1 1/2" 3 pc Coupling \$  
 Compound Joints at \$  
 1 Maintenance Foreman BRASS Bushing \$  
 Hrs. Water Maint. Man-1 at 2" to 1 1/2" \$  
 Hrs. Water Maint. Man-2 at \$  
 Hrs. Garage Foreman at \$  
 Hrs. Labor at \$  
 Hrs. Compressor at \$  
 Compensation Ins. at \$ per C \$  
 Trucking \$  
 Pav't Patch \$  
 Tap MADE BY Beecher \$ 46  
 Aug-14-1973 \$  
 O'head \$

BAY St. No. 54  
 Ave. No. 54

Name of Owner  
 Methodist Christ Church

Labor and Mat'l. Report Aug 14 19 73

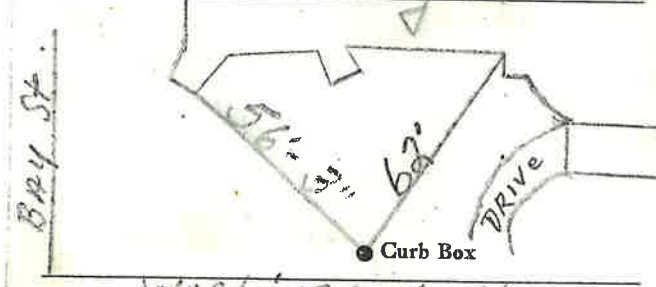

WASHINGTON ST  
 8" Main Elev. of Main at tap 5'  
 Gate at • Gate at

• Curb Box