

LABOR AND MATERIALS

1 Copper } Connection 3/4" ^{with 450 Bend.} \$ _____
 1 Lead }
 1 Curb } Cock } 3/4" in. \$ _____
 } Valve }
 } T. S. & V. }
 1 Service box { Short 3 1/2 x 4 1/2 }
 Old returned { Long 4 1/2 x 5 1/2 }
 { Buff. or Rdway } \$ _____
 20 Ft. 3/4" in. { Copper } Pipe at \$ _____
 { G. I. }
 { C. I. }
 Nipples _____ in. at \$ _____
 Bushings _____ to _____ in. at \$ _____
 Red'g }
 Inc'g } Coupl'gs _____ to _____ in. at \$ _____
 Union _____ in. at \$ _____
 Meter _____ in. at \$ _____
 Lead Joints at \$ _____
 Compound Joints at \$ _____
 Maintenance Foreman \$ _____
 Hrs. Water Maint. Man—1 at \$ _____
 Hrs. Water Maint. Man—2 at \$ _____
 Hrs. Garage Foreman _____ at \$ _____
 Hrs. Labor _____ at \$ _____
 Hrs. Compressor at \$ _____
 Compensation Ins. at \$ _____ per C \$ _____
 Trucking \$ _____
 Pav't Batch \$ _____
Tap by Gifford & Co \$ _____
4-29-60. \$ _____
 O'head \$ _____
 \$ _____

✓ Tap 84-1960
 Bush

St. _____
 Pl. _____
 Ave. No. 47

Name of Owner

Harold Warner.

Labor and Mat'l. Report

April 29 1960

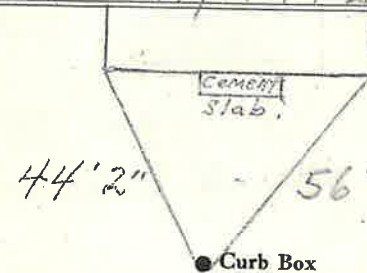

6" Main

Elev. of Main at tap 6 1/2

Gate at ●

● Gate at

● Curb Box

Re-measured 5-3-67
 by Lareau & Habshi.