

LABOR AND MATERIALS

1	Copper Lead	Connection	3/4"	\$	2.71
1	Curb	Cock Valve T.S. & V.	3/4 in.	\$	3.83
1	Service box	Short 3 1/2 x 4 1/2		\$	4.69
	Old returned	Long 4 1/2 x 5 1/2		\$	
		Buff or Rdway		\$	
35	Ft. 3/4 in.	Copper Pipe at	45	\$	15.75
	Nipples	in. at		\$	
	Bushings	to in. at		\$	
	Red'g			\$	
	Inc'g	Coupl'gs to in. at		\$	
	Union	in. at		\$	
	Meter	in. at		\$	
	Lead Joints	at		\$	
	Compound Joints	at		\$	
	Maintenance Foreman			\$	
	Hrs. Water Maint. Man-1	at		\$	
10	Hrs. Water Maint. Man-2	at 1.24		\$	12.40
	Hrs. Garage Foreman	at		\$	
20	Hrs. Labor	at 1.13		\$	22.60
	Hrs. Compressor	at		\$	
	Compensation Ins.	at \$ 4.29 per C		\$	1.50
	Trucking			\$	1.50
	Pav't Patch			\$	
	Tap by Gifford			\$	
				\$	
	O'head			\$	
				\$	
				\$	64.98

Byrno St. Pl. Ave. No. 50

Name of Owner Madonna

Labor and Mat'l. Report Aug. 23 1955

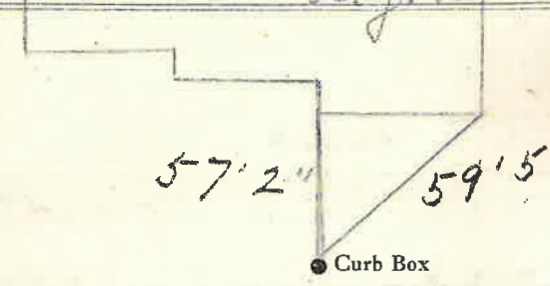

12" Main Elev. of Main at tap 5'

Gate at • • Gate at

TAX ID # 303.13-4-5

• Curb Box