

LABOR AND MATERIALS

1	Copper Lead	Connection	3/4	\$
1	Curb	Cock Valve P.S. & V.	3/4 in.	\$
	Service box	Short 3 1/2 x 4 1/2		
	Old returned	Long 4 1/2 x 5 1/2		\$
24	Ft.	3/4" in.	{ Copper } { G.I. } { G.I. }	Pipe at \$
	Nipples	in. at		\$
	Bushings	to in. at		\$
	Red'g Inc'g	Coupl'gs	to in. at	\$
	Union	in. at		\$
	Meter	in. at		\$
	Compound Joints	at		\$
	Maintenance Foreman			\$
	Hrs. Water Maint. Man-1	at		\$
	Hrs. Water Maint. Man-2	at		\$
	Hrs. Garage Foreman	at		\$
	Hrs. Labor	at		\$
	Hrs. Compressor	at		\$
	Trucking			\$
	Pav't Patch			\$
				\$
				\$
				\$
				\$
				\$

St. CHERRY  
 Pl. 49  
 Ave. No. 49

---

Name of Owner \_\_\_\_\_

Labor and Mat'l. Report NOV 1930

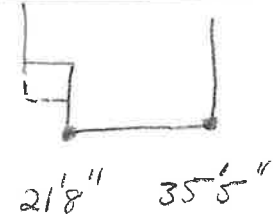

● Curb Box

12" Main Elev. of Main at tap 4 1/2'

Gate at ● Gate at ●

● Curb Box