

LABOR AND MATERIALS

1	Copper	Connection } 3/4 in.	\$	
1	Lead			
1	Curb	Cock Valve } 3/4 in. T. S. & V. }	\$	
1	Service box			} Short 3 1/2 x 4 1/2 Long 4 1/2 x 5 1/2 Buff or Rdway }
1	Old returned			
27	Ft.	3/4 in. } Copper	\$	
		} G. I.		
		} G. I.		
		} Pipe at		
	Nipples	in. at	\$	
	Bushings	to in. at	\$	
	Red'g } Inc'g }	Coupl'gs to in. at	\$	
	Union	in. at	\$	
	Meter	in. at	\$	
	Lead Joints	at	\$	
	Compound Joints	at	\$	
	Maintenance Foreman		\$	
	Hrs. Water Maint. Man—1	at	\$	
	Hrs. Water Maint. Man—2	at	\$	
	Hrs. Garage Foreman	at	\$	
	Hrs. Labor—	at	\$	
	Hrs. Compressor	at	\$	
	Compensation Ins. at \$	per C	\$	
	Trucking		\$	
	Pav't Patch		\$	
	Top by Giesbard & Co. - 7-30-58.			
	O'head		\$	

Top by Giesbard & Co. - 7-30-58.

St. ~~Clayton~~  
Pl. Ave. No. 14.

Name of Owner  
Douglas Steele

Labor and Mat'l. Report July 30 1958

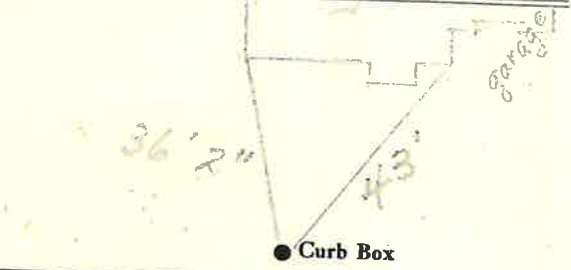

6" Main Elev. of Main at tap 6'  
Gate at ● ● Gate at ●

● Curb Box