

LABOR AND MATERIALS

1 Copper } Connection \_\_\_\_\_ \$  
 Lead }  
 Curb } Cook } 6 in. \$  
       } Valve }  
       } T. S. & V. }  
 1 Service box { Short 3 1/2 x 4 1/2 }  
 Old returned { Long 4 1/2 x 5 1/2 }  
                   { Buff or Rdway } \_\_\_\_\_ \$  
 16 Ft. 6 in. { Copper }  
                   { C. I. } Pipe at \_\_\_\_\_ \$  
                   { C. I. }  
 Nipples in. at \_\_\_\_\_ \$  
 Bushings to in. at \_\_\_\_\_ \$  
 Red'g }  
 Inc'g } Coupl'gs to in. at \_\_\_\_\_ \$  
 Union in. at \_\_\_\_\_ \$  
 Meter in. at \_\_\_\_\_ \$  
 Lead Joints at \_\_\_\_\_ \$  
 Compound Joints at \_\_\_\_\_ \$  
 Maintenance Foreman \_\_\_\_\_ \$  
 Hrs. Water Maint. Man-1 at \_\_\_\_\_ \$  
 Hrs. Water Maint. Man-2 at \_\_\_\_\_ \$  
 Hrs. Garage Foreman at \_\_\_\_\_ \$  
 Hrs. Labor- at \_\_\_\_\_ \$  
 Hrs. Compressor at \_\_\_\_\_ \$  
 Compensation Ins. at \$ \_\_\_\_\_ per C. \$  
 Trucking \_\_\_\_\_ \$  
 Pav't Patch \_\_\_\_\_ \$  
 Tap by Larreau & Co. \_\_\_\_\_ \$  
                                   9-9-71 \_\_\_\_\_ \$  
 O'head \_\_\_\_\_ \$  
 \_\_\_\_\_ \$

St. Cooper  
 Pt. 29  
 Ave. No. 29

Name of Owner The Post Star & Times

Labor and Mat'l. Report Sept. 9 1971

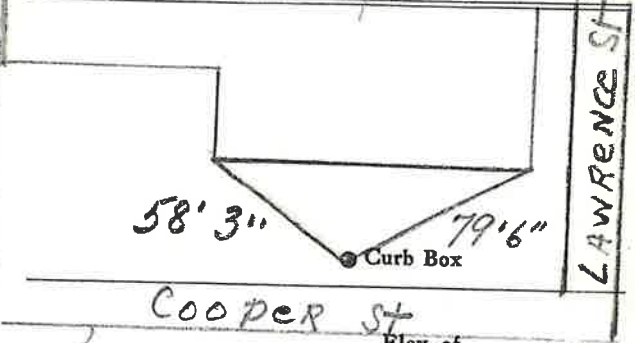

6 Main Elev. of Main at tap 5'  
 Gate at • Gate at •

• Curb Box  
 6" Sprinkler System.

LABOR AND MATERIALS

1	Copper Lead	} Connection	1 1/2"	\$	
1	Curb		Cock Valve T. S. & V. } 2 in.	\$	
1	Service box - Old returned	} Short 3 1/2 x 4 1/2 Long 4 1/2 x 5 1/2 Buff or Rdway	} Oriseal.	\$	
20	Ft. 2 in.			} Copper G.I. G.I.	} Pipe at. \$
	Nipples				
	Bushings	to in. at \$			
	Red'g Inc'g	} Coupl'gs	to in. at \$		
	Union		in. at \$		
	Meter	in. at \$			
	Lead Joints	at \$			
	Compound Joints	at \$			
	Maintenance Foreman	\$			
	Hrs. Water Maint. Man-1	at \$			
	Hrs. Water Maint. Man-2	at \$			
	Hrs. Garage Foreman	at \$			
	Hrs. Labor	at \$			
	Hrs. Compressor	at \$			
	Compensation Ins.	at \$ per C			
	Trucking	\$			
	Pav't Patch	\$			
	Tap by Lareau & Co	\$			
	9-9-71.	\$			
	O'head	\$			

Cooper  
 St. "Pl." Ave. No. 29  
 Name of Owner  
 The Post Star & Times  
 Labor and Mat'l. Report Sept. 7 1971

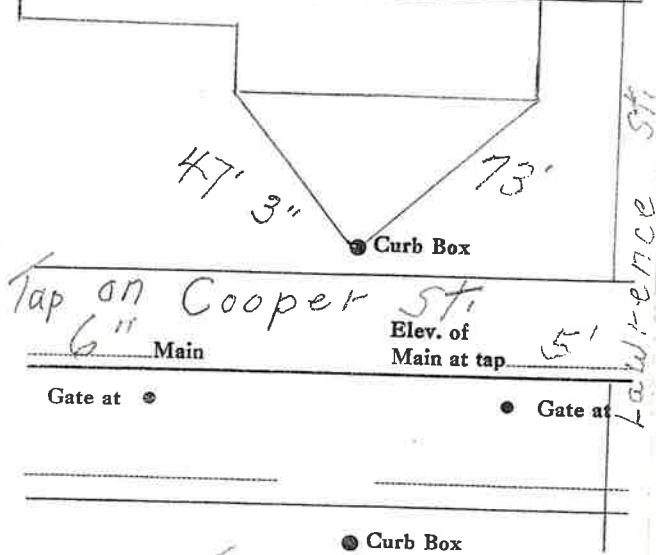

Gate at ● Gate at ●  
 Curb Box  
 2" Tap  
 Elev. of Main at tap 5'