

LABOR AND MATERIALS

Same	Copper Lead	Connection	3/4"	\$	—
2	Curb	Cock Valve T.S. & V.	3/4 in. 349	\$	6.98
Same	Service box Old returned	Short 3 1/2 x 4 1/2 Long 4 1/2 x 5 1/2 Buff. or Rdway		\$	—
21	3/4 in.	Copper G.I. Pipe at	40	\$	8.40
	Nipples	in. at		\$	
	Bushings	to in. at		\$	
	Red'g Inc'g	Coupl'gs. to in. at		\$	
	Union	in. at		\$	
	Meter	in. at		\$	
	Lead Joints at			\$	
	Compound Joints at			\$	
	Maintenance Foreman			\$	
14	Hrs. Water Maint. Man-1	at 1.41		\$	19.74
8	Hrs. Water Maint. Man-2	at 1.24		\$	9.92
1	Hrs. Garage Foreman	at 1.59		\$	1.59
57	Hrs. Labor	at 1.13		\$	64.41
	Hrs. Compressor at			\$	
	Compensation Ins. at \$	3.06 per C.		\$	3.55
	Trucking			\$	1.50
	Pay't Patch			\$	20.16
	Tap by Warsinski			\$	
				\$	
	O'head			\$	
				\$	136.75

Leak

11:09

7-54

St. Cooper
 Pl. Cooper
 Ave. No. 49
 Name of Owner Glens Falls Machine Works
 Labor and Mat'l. Report Feb. 4 1954

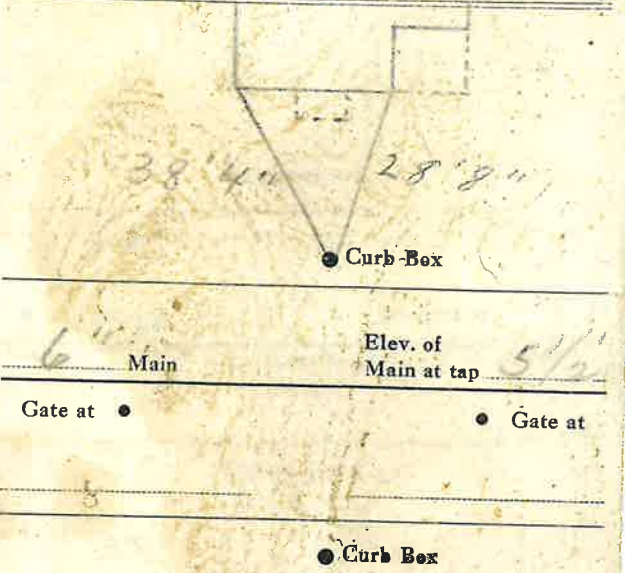

To be raged - 1999