

LABOR AND MATERIALS

Copper	} Connection		\$	
Lead				
Curb	} Cock Valve T. S. & V. }	in.	\$	
Service box		} Short 3 1/2 x 4 1/2 Long 4 1/2 x 5 1/2 }		\$
Old returned				
10 Ft. 3/4 in.	} Copper C. I. C. I. }	Pipe at	\$	
Nipples		in. at	\$	
Bushings	to	in. at	\$	
Red'g Inc'g	} Coupl'gs	to	in. at	
Union		in. at	\$	
Meter	in. at	\$		
Compound Joints	at	\$		
Maintenance Foreman		\$		
Hrs. Water Maint. Man-1	at	\$		
Hrs. Water Maint. Man-2	at	\$		
Hrs. Garage Foreman	at	\$		
Hrs. Labor	at	\$		
Hrs. Compressor	at	\$		
Trucking		\$		
Pav't Patch		\$		
		\$		
		\$		
		\$		
		\$		

CRAWDALL St. No. 63

Name of Owner

Labor and Mat'l. Report JUNE 12 2000

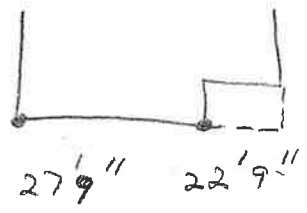

● Curb Box

10" Main Elev. of Main at tap 4'

Gate at ● Gate at

● Curb Box

* REPLACED OLD GALV. SERVICE WITH 3/4" COPPER - JUNE 12 2000

LSM-5C-6-1-67

* BECAUSE OF A LEAK