

LABOR AND MATERIALS

1 Copper } Connection 2" \$
 Lead }
 1 Curb } Cock } 2 in. \$
 Valve }
 T.S. & V. } *Or seat curb box*
 1 Service box } Short 3 1/2 x 4 1/2 \$
 Old returned } Long 4 1/2 x 5 1/2 \$
 Buff or Rdway }
 20 Ft. 2 in. } Copper } Pipe at \$
 C.I. }
 C.I. }
 Nipples in. at \$
 Bushings to in. at \$
 Red'g }
 Inc'g } Coupl'gs to in. at \$
 Union in. at \$
 Meter in. at \$
 Lead Joints at \$
 Compound Joints at \$
 Maintenance Foreman \$
 Hrs. Water Maint. Man-1 at \$
 Hrs. Water Maint. Man-2 at \$
 Hrs. Garage Foreman at \$
 Hrs. Labor at \$
 Hrs. Compressor at \$
 Compensation Ins. at \$ per C \$
 Trucking \$
 Pav't Patch \$
Tap by Gifford & Co. \$
8-9-67. \$
 O'head \$
 \$

Crandall St. Pl. Ave. No. *8*

Name of Owner *New St. Alphonsus School*

Labor and Mat'l. Report *Aug. 9* 19 *67.*

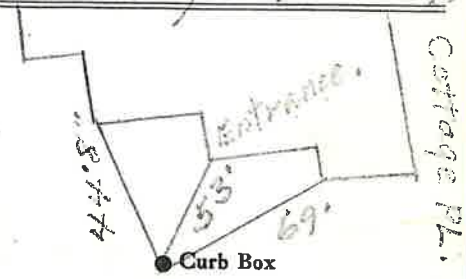

Crandall St.
 8" Main Elev. of Main at tap *5'*

Gate at • Gate at

• Curb Box
 2" Tap on *Crandall St.*

Labor and Materials

1	Lead Connection	3/4	\$
1	Curb Cock		\$
	Service Box	(Short 3 1/2 x 4 1/2)	\$
	Old returned	(Long 4 1/2 x 6 1/2 - Buffalo)	\$
14	Ft. in. G. I. Pipe at		\$
	Nipples	in. at	\$
	Bushings	1 to 1/2 in. at	\$
	Red'g Coup	to in. at	\$
	Inc'g Coup	to in. at	\$
	Union	in. at	\$
	Meter	in. at	\$
	Cu. Yds. Br. Stone at		\$
	Cu. Yds. Sand at		\$
	Bags Cement at		\$
	Paving Brick	{ Mack Red Asphalt } at	\$
5	Hrs. Foreman at		\$
17	Hrs. Common Labor at		\$
	Hrs. Mason at		\$
	Hrs.	at	\$
	Hrs.	at	\$
2.1	Builders' Use of Water		\$
	Truck	100	\$
		at	\$
		at	\$
		at	\$
		at	\$
	Total	\$	19.56

Labor and Material Report Oct 4 1924

3/4 Tap for 8" Crandell (Stub)

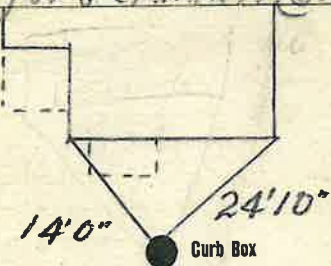

8" Main

Elev. of Main at tap

Gate at ●

● Gate at

See other card, 818 1/2

● Curb Box

This Tap is not connected to
Main 2" Hoses in connection

Labor and Materials

1	Lead Connection	\$
	Curb Cock	\$
	Service Box (Short 3 1/2 x 4 1/2)	\$
	Old returned (Long 4 1/2 x 5 1/2)	\$
17	Ft. in. G. I. Pipe at	\$
	Nipples in. at	\$
	Bushings to in. at	\$
	Red'g Coup to in. at	\$
	Inc'g Coup to in. at	\$
	Union in. at	\$
	Meter in. at	\$
	Cu. Yds. Br. Stone at	\$
	Cu. Yds. Sand at	\$
	Bags Cement at	\$
	Paving Brick { Mack Red Asphalt } at	\$
5	Hrs. Foreman at	\$
17	Hrs. Common Labor at	\$
	Hrs. Mason at	\$
	Hrs. at	\$
	Hrs. at	\$
21.5	Builders' Use of Water	\$
	at	\$
	Truck 1.00	\$
	at	\$
	at	\$
	at	\$
	Total	\$ 19.08

Labor and Material Report Oct 4 1924

3/4 tap at 2 bendell w/for 8 1/2

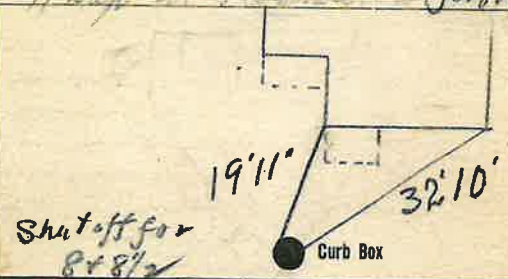

9" Main Elev. of Main at tap 4 1/2

Gate at ● Gate at ●

● Curb Box