

LABOR AND MATERIALS

1	Copper Lead	Connection	3/4"	\$
1	Curb	Cock Valve T.S. & V.	3/4 in.	\$
1	Service box Old returned	Short 3 1/2 x 4 1/2 Long 4 1/2 x 5 1/2 Buff or Rdway		\$
14	Ft	3/4 in. Copper C.I. C.I. Pipe at		\$
	Nipples	in. at		\$
	Bushings	to in. at		\$
1	Red'g Inc'g	Coupl'gs 1 to 3/4 in. at		\$
	Union	in. at	Brass	\$
	Meter	in. at		\$
	Lead Joints	at		\$
	Compound Joints	at		\$
	Maintenance Foreman			\$
	Hrs. Water Maint. Man-1	at		\$
	Hrs. Water Maint. Man-2	at		\$
	Hrs. Garage Foreman	at		\$
	Hrs. Labor	at		\$
	Hrs. Compressor	at		\$
	Compensation Ins.	at \$ per C		\$
	Trucking			\$
	Pav't Patch			\$
	Tap by Giesbard & Co			\$
				\$
				\$
	O'head			\$

WHITEMAN'S USED CARS

Dix St. Pl. 78-80 Ave. No.

Name of Owner Bud Culver

Labor and Mat'l. Report April 20 1961

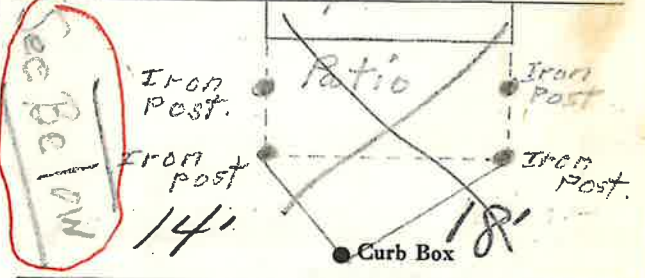

6" UNCAS ST Elev. of Main at tap

Gate at • Gate at • New Bldg

3/15/61 UNCAS ST. Curb Box

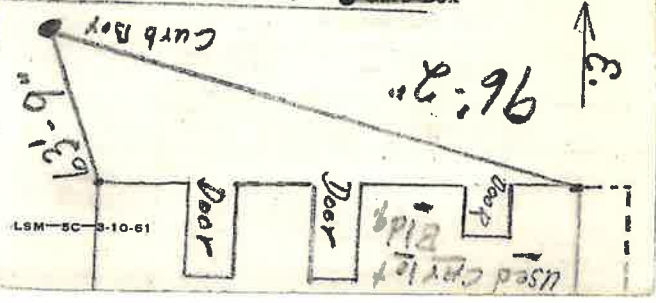

LSM-5C-3-10-61

WHITENHANS USED CARS

Dix St  
Pl. 78-80  
Ave. No.

Name of Owner

Bud Culver

Labor and Mat'l Report April 20 1961

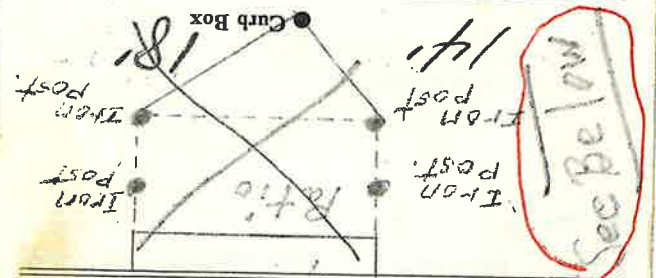

UNCAS ST

Elev. of Main  
Main at tap

Gate at

Boyerman

4 1/2 ft

UNCAS ST

Curb Box

Curb Box

96'-2"  
3'

139'-9"

LSM-2C-9-10-61

Door

Door

Door

Used car lot Bldg