

LABOR AND MATERIALS

1	Copper Lead	Connection	3/4	\$	2.80
1	Curb	Clock Valve T. S. & V.	3/4 in.	\$	3.60
1	Service box	Short 3 1/2 X 4 1/2 Long 4 1/2 X 5 1/2 Buff or Rdway		\$	5.80
	Old returned				
10	Ft.	Copper Galv. Iron Cast Iron	3/4 in. Pipe at 35	\$	3.50
	Nipples		in. at	\$	
	Bushings		to in. at	\$	
	Red'g Incl'g	Couplings	to in. at	\$	
	Union		in. at	\$	
	Meter	in. at	\$		
	Lead Joints	at	\$		
	Compound Joints	at	\$		
	Hrs. Foreman	at	\$		
6	Hrs. Chauffeur	at 8 1/2	\$	4.95	
	Hrs. Tapper	at	\$		
6	Hrs. Labor	at 7 1/2	\$	4.29	
	Hrs. Labor	at	\$		
	Hrs. Compressor	at	\$		
	Compensation Ins.		\$	20	
	Trucking		\$	1.20	
	Builders Use of Water		\$		
			\$		
			\$		
			\$		
			\$		
			\$	26.14	

Total Workman's fee

5-47

6

St.

Pl.

Ave. No. 2

Dudley

Raiscailt

Labor and Mat'l. Report

April 29 1947

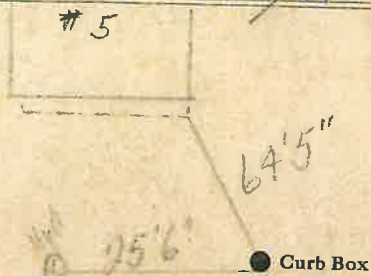

4 Main

Elev. of

Main at tap

5

Gate at ●

● Gate at

● Curb Box

MEASURED FROM

#5

For #6
Dudley St.
New House

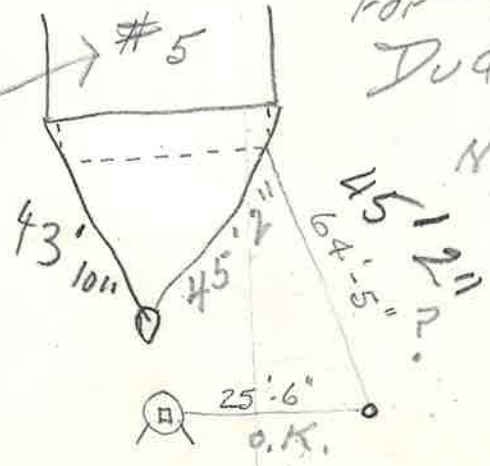

□

25' 6"
o.k.

64' 5"
45' 2"