

LABOR AND MATERIALS

1	Copper Lead	Connection	3/4" St. op	\$	79
1	Curb	Cock Valve F. S. & V.	3/4" in.	\$	180
1	Service Box Old returned	Short 3 1/2 x 4 1/2 Long 4 1/2 x 5 1/2 Buffer Rdway		\$	170
11	Ft.	3/4" in.	Copper Galv Iron Cast Iron	Pipe at	18 \$ 1.98
1	Nipples	3/4" in.	at 3" hang	\$	18
1	Bushings	1" to 3/4" in.	at	\$	25
	Red'g Inc'g	Couplings	to 1/4" in.	at	\$
	Union		in.	at	\$
	Meter		in.	at	\$
1	Lead Joints			at	\$
	Leadite Joints			at	\$
	Hrs. Foreman			at	\$
7	Hrs. Chauffeur		6.2 hr	\$	4.39
	Hrs. Tapper			at	\$
21	Hrs. Labor		45	\$	9.45
	Hrs. Labor			at	\$
14 1/2	Hrs. Compressor		6.2 hr	\$	94
	Compensation Ins.			\$	42
	Trucking			\$	1-
1	Builders Use of Water	Patch		\$	9-
				\$	
				\$	
				\$	
				\$	
				\$	
				\$	
				\$	
				\$	31.27

1 2 2 1941

St.

Exchange

Ave. No. 16

Name of Owner

Capone

Labor and Mat'l. Report

Oct 15 1941

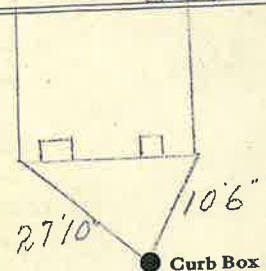

2" Transite
2" Gate
Main

Elev. of
Main at tap 6 1/2

Gate at ● Gate at ●

● Curb Box

H