

# LABOR AND MATERIALS

1	Copper } Connection	3/4	\$	
1	Curb } Cock	3/4 in.	\$	
	Valve			
1	Service box { Short 3-1/2 x 4-1/2		\$	
	Old returned { Long 4-1/2 x 5-1/2		\$	
23	Ft. 3/4 in. { Copper		\$	
	Nipples	in. at	\$	
	Bushings	to in. at	\$	
	Red'g			
	Inc'g			
	Union	in. at	\$	
	Meter	in. at	\$	
			\$	
	Compound Joints at		\$	
	Maintenance Foreman		\$	
	Hrs. Water Maint. Man - 1 at		\$	
	Hrs. Water Maint. Man - 2 at		\$	
	Hrs. Garage Foreman	at	\$	
	Hrs. Labor	at	\$	
	Hrs. Compressor at		\$	
			\$	
	Trucking		\$	
	Pav't Patch		\$	
			\$	
			\$	
			\$	
			\$	
			\$	

St. FULTON  
 Ave. No. 3  
 Name of Owner \_\_\_\_\_

Labor and Mat'l. Report 1930, JUNE 6.

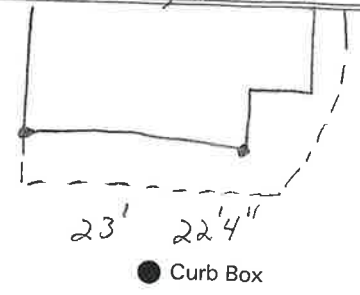

10" Main  
 Elev. of Main at tap 5 1/2'  
 Gate at ● Gate at ●

● Curb Box