

LABOR AND MATERIALS

1	Copper } Connection		\$	
1	Lead } Cock		\$	
1	Curb } Valve		\$	
		in.		
1	Service box { Short 3-1/2 x 4-1/2		\$	
	Old returned { Long 4-1/2 x 5-1/2		\$	
10	Ft. $\frac{3}{4}$ in. { Copper		\$	
		Pipe at		
	Nipples	in. at	\$	
1	Bushings $\frac{3}{4}$ to $\frac{1}{2}$	in. at	\$	
	Red'g			
	Inc'g			
	Union	in. at	\$	
	Meter	in. at	\$	
			\$	
	Compound Joints at		\$	
	Maintenance Foreman		\$	
	Hrs. Water Maint. Man - 1 at		\$	
	Hrs. Water Maint. Man - 2 at		\$	
	Hrs. Garage Foreman	at	\$	
	Hrs. Labor	at	\$	
	Hrs. Compressor at		\$	
			\$	
	Trucking		\$	
	Pav't Patch		\$	
			\$	
			\$	
			\$	
			\$	

St. GARFIELD No. 15
 Name of Owner _____

Labor and Mat'l. Report 1931, APR. 15

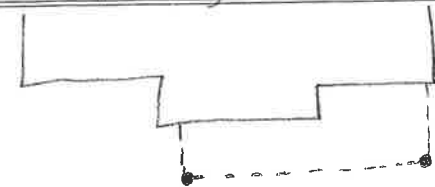

23'7" 28'8"

● Curb Box

6" Main

Elev. of Main at tap 5'

Gate at ●

● Gate at

● Curb Box