

## LABOR AND MATERIALS

Copper } Connection.....		\$
Lead } .....		\$
Curb { Cock Valve } .....	in.	\$
{ T. S. & V. } .....		\$
Service Box } Short 3 1/2 x 4 1/2 } .....		\$
Old returned } Long 4 1/2 x 5 1/2 } .....		\$
{ Buff or Rdway } .....		\$
20 Ft. 3/4 in. } Copper } Pipe at.....		\$
{ Galv Iron } .....		\$
{ Cast Iron } .....		\$
Nipples.....	in. at	\$
Bushings .....	to..... in. at	\$
Red'g } Couplings.....	to..... in. at	\$
Inc'g } .....		\$
Union.....	in. at	\$
Meter.....	in. at	\$
Lead Joints at .....		\$
Leadite Joints at .....		\$
Hrs. Foreman at .....		\$
Hrs. Chauffeur at .....		\$
Hrs. Tapper at .....		\$
Hrs. Labor at .....		\$
Hrs. Labor at .....		\$
Hrs. Compressor at .....		\$
Compensation Ins. ....		\$
Trucking .....		\$
Builders Use of Water .....		\$
.....		\$
.....		\$
.....		\$
.....		\$
.....		\$
.....		\$
.....		\$
.....		\$
.....		\$
.....		\$

St. Garfield  
 Pt.             
 Ave. No. 30

Name of Owner  
TAP MADE 5-7-31

Labor and Mat'l. Report **AUG 24 1939** 19

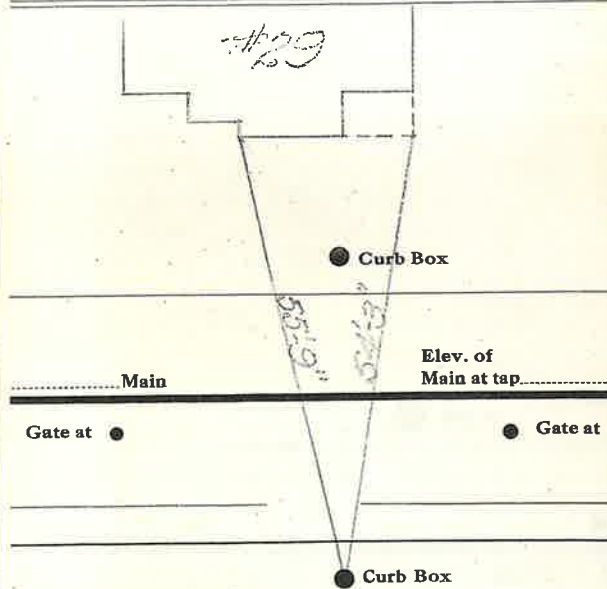

*Vacant Lot*  
 Measured from  
 29 Garfield St