

LABOR AND MATERIALS

1	Copper	} Connection	3 1/2"	\$	2.41			
	Lead							
1	Curb	} Cock Valve T.S.&V.	} 3 1/4 in.	\$	3.41			
1	Service box					} Short 3 1/2 x 4 1/2 Long 4 1/2 x 5 1/2 Buff or Rdway.	\$	4.18
	Old returned							
16	Ft. 3/4 in.	} Copper G.I. C.I.	} Pipe at 40	\$	6.40			
	Nipples	in. at		\$				
	Bushings	to in. at		\$				
	Red'g Inc'g	} Coupl'gs	to in. at	\$				
	Union					in. at	\$	
	Meter	in. at		\$				
	Lead Joints	at		\$				
	Compound Joints	at		\$				
	Maintenance Foreman			\$				
	Hrs. Water Maint. Man-1	at		\$				
7	Hrs. Water Maint. Man-2	at 1.24		\$	868			
	Hrs. Garage Foreman	at		\$				
8	Hrs. Labor	at 1.13		\$	9.04			
	Hrs. Compressor	at		\$				
	Compensation Ins. at	\$3.861 per C.		\$	68			
	Trucking			\$	1.50			
	Pav't Patch			\$	14.90			
	Tap by Giggard	6-24-51		\$				
	O'head			\$				
				\$	50.70			

26.30

42-54

St.
Pl.
Ave. No. 217

Name of Owner

Shipton

Labor and Mat'l. Report

1954

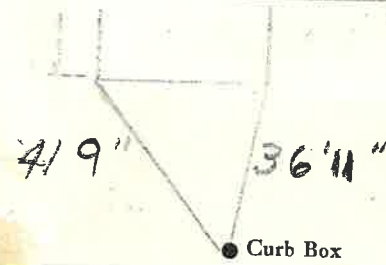

● Curb Box

6" Main

Elev. of
Main at tap 5'

Gate at ●

● Gate at

TA ID # 302.12-7-14

● Curb Box