

LABOR AND MATERIALS

1	Copper Lead	Connection	$\frac{3}{4}$		\$
1	Curb	Cock Valve T.S. & V.	$\frac{3}{4}$ in.		\$
1	Service box Old returned	Short $3\frac{1}{2} \times 4\frac{1}{2}$ Long $4\frac{1}{2} \times 5\frac{1}{2}$ Buff or Rdway			\$
10	Ft. $\frac{3}{4}$ in.	Copper C.I. C.I.	Pipe at		\$
	Nipples	in. at			\$
	Bushings	to in. at			\$
	Red'g Inc'g	Coupl'gs	to in. at		\$
	Union	in. at			\$
	Meter	in. at			\$
	Lead Joints	at			\$
	Compound Joints	at			\$
	Maintenance Foreman				\$
	Hrs. Water Maint. Man-1	at			\$
	Hrs. Water Maint. Man-2	at			\$
	Hrs. Garage Foreman	at			\$
	Hrs. Labor	at			\$
	Hrs. Compressor	at			\$
	Compensation Ins.	at \$	per C		\$
	Trucking				\$
	Pav't Patch				\$
					\$
					\$
	O'head				\$
					\$

Total of items

12
11
10

St.
Pl.
Ave. No. 83

BAY 83

Name of Owner _____

Labor and Mat'l. Report 19

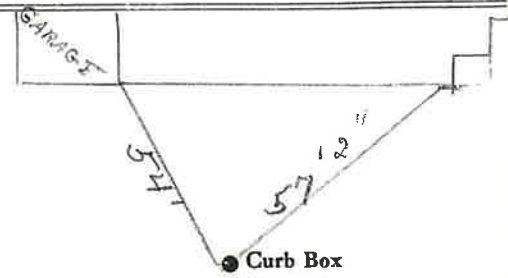

10 Main Elev. of
Main at tap 5

Gate at ● ● Gate at

● Curb Box