

LABOR AND MATERIALS

1	Copper Lead	Connection	3/4	\$
1	Curb	Cook Valve T.S. & V.	3/4 in.	\$
1	Service box Old returned	Short 3 1/2 x 4 1/2 Long 4 1/2 x 5 1/2 Buff or Rdway		\$
11	Ft.	Copper C.I. C.I.	3/4 in. Pipe at	\$
	Nipples	in. at		\$
	Bushings	to in. at		\$
	Red'g Inc'g	Coupl'gs to in. at		\$
	Union	in. at		\$
	Meter	in. at		\$
	Lead Joints at			\$
	Compound Joints at			\$
	Maintenance Foreman			\$
	Hrs. Water Maint. Man-1 at			\$
	Hrs. Water Maint. Man-2 at			\$
	Hrs. Garage Foreman at			\$
	Hrs. Labor at			\$
	Hrs. Compressor at			\$
	Compensation Ins. at \$	per C		\$
	Trucking			\$
	Pay't Patch			\$
				\$
				\$
	O'head			\$
				\$

BAY

St. Pl. 102 Ave. No. 102 1/2

Name of Owner _____

TAX ID # 302.16-19-2.2

TAP ON WASHBURN

Labor and Mat'l. Report 19

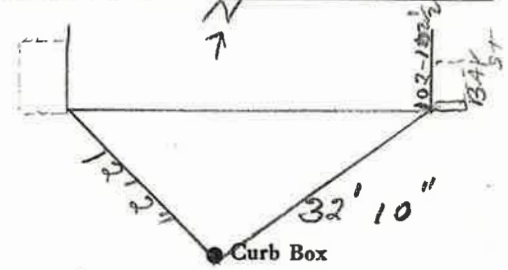

6 Main Elev. of Main at tap 5 1/2

Gate at • • Gate at

• Curb Box