

LABOR AND MATERIALS

1	Copper	Connection	3/4		\$ 2.94
	Lead				
1	Curb	Cock Valve	3/4	in.	\$ 3.71
		T. S. & V.			
	Service box	Short 3 1/2 X 4 1/2			
	Old returned	Long 4 1/2 X 5 1/2			
		Buff or Rdway		Same	\$ —
11	Ft.	Copper	3/4	in.	
		G. I.		Pipe at 30	\$ 3.30
		C. I.			
	Nipples	in. at			\$
	Bushings	to in. at			\$
	Red'g				
	Inc'g	Coupl'gs to in. at			\$
	Union	in. at			\$
	Meter	in. at			\$
	Lead Joints	at			\$
	Compound Joints	at			\$
2	Hrs. Water Maint. Man-1	at	1.17		\$ 2.24
2	Hrs. Water Maint. Man-2	at	1.07		\$ 2.14
23	Hrs. Labor-	at	91		\$ 209.30
	Hrs. Labor-	at			\$
1	Hrs. Compressor at		1.20		\$ 1.20
	Compensation Ins. at \$	per C			\$ 67
	Trucking				\$ 1.00
	Pav't Patch				\$ 12.00
	Tap by Magnium				\$
	O'head				\$
					\$ 55.13

4

Big Cross St.  
 Ave. No. 4

Name of Owner  
 Boyer

Labor and Mat'l. Report Sept 8 1948

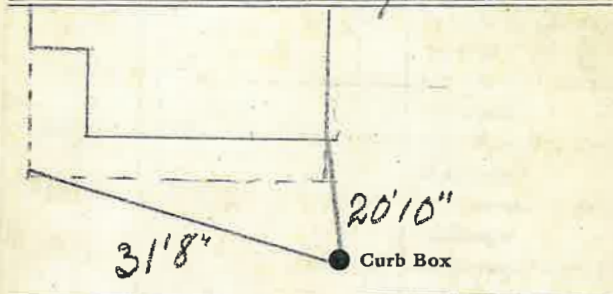

4 Main Elev. of Main at tap 5  
 Gate at ● Gate at ●

TAX ID # 309.12-7-16

● Curb Box