

LABOR AND MATERIALS

1	Copper Lead	Connection	3/4"	\$
1	Curb	Cock Valve T. S. & V.	3/4" in.	\$
	Service Box Old returned	Short 3 1/2 x 4 1/2 Long 4 1/2 x 5 1/2 Buffer Rdway		\$
11	Ft.	3/4" in.	Copper Galv Iron Cast Iron	Pipe at \$
	Nipples			in. at \$
	Bushings			to in. at \$
	Red'g Inc'g	Couplings		to in. at \$
	Union			in. at \$
	Meter			in. at \$
	Lead Joints			at \$
	Leadite Joints			at \$
	Hrs. Foreman			at \$
	Hrs. Chauffeur			at \$
	Hrs. Tapper			at \$
	Hrs. Labor			at \$
	Hrs. Labor			at \$
	Hrs. Compressor			at \$
	Compensation Ins.			\$
	Trucking			\$
	Builders Use of Water			\$

1-3/4" Cop. to Cop Coupling
 3-3/4" K. Copper used
 To repair leak 9-24-54

St.
 Pl.
 Ave. No. 4

Bowman

Name of Owner

Snider

Measured in

Labor and Mat'l. Report AUG 23 1939 19

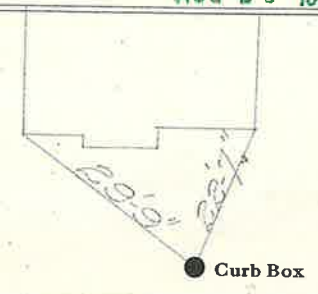

6" Main Elev. of Main at tap 51

Gate at ● Gate at ●

● Curb Box

Leak Developed AND
 Was Dog up ground
 Copper Pipe.
 Repaired - 9-24-54.