

### LABOR AND MATERIALS

Copper	} Connection	_____	\$	
Lead				
Curb	} Cock Valve T. S. & V. }	_____ in.	\$	
Service box		{ Short 3½ x 4½ Long 4½ x 5½ Buff or Rdway }	_____	\$
Old returned				
_____ 24 Ft. _____ in.	{ Copper G.I. C.I. }		Pipe at 3/4" _____	\$
Nipples	_____ in.	at _____	\$	
Bushings	_____ to _____	in. at _____	\$	
Red'g	} Coupl'gs	_____ to _____	in. at _____	\$
Inc'g				
Union	_____ in.	at _____	\$	
Meter	_____ in.	at _____	\$	
Lead Joints	at _____		\$	
Compound Joints	at _____		\$	
Maintenance Foreman	_____		\$	
Hrs. Water Maint. Man-1	at _____		\$	
Hrs. Water Maint. Man-2	at _____		\$	
Hrs. Garage Foreman	at _____		\$	
Hrs. Labor	_____ at _____		\$	
Hrs. Compressor	at _____		\$	
Compensation Ins.	at \$ _____ per C		\$	
Trucking	_____		\$	
Pav't Patch	_____		\$	
_____			\$	
_____			\$	
_____			\$	
O'head	_____		\$	
_____			\$	

W. Baylston

St.  
Pl.  
Ave. No. 33

Name of Owner

Robert Whipple

Labor and Mat'l. Report

Aug 18

1977

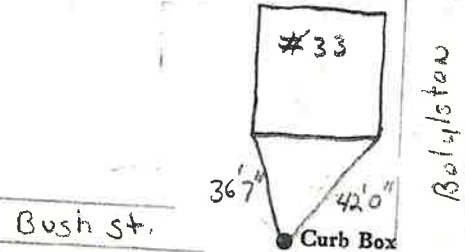

6" Main

Elev. of  
Main at tap \_\_\_\_\_

Gate at ●

● Gate at \_\_\_\_\_

● Curb Box

CURB STOP BEHIND FENCE -  
BUSH ST SIDE