

LABOR AND MATERIALS

1 Copper } Connection 2" \$
 1 Curb } Cock } 2" in. oriseal
 } Valve }
 } T.S. & V. }
 1 Service box } Short 3 1/2 x 4 1/2 } 4' x 5'
 Old returned } Long 4 1/2 x 5 1/2 } oriseal
 } Buff. or Rdway }
 32 Ft. 2 in. } Copper } Pipe at \$
 } C.I. }
 } C.I. }
 Nipples in. at \$
 Bushings to in. at \$
 Red'g } Coupl'gs to in. at \$
 Inc'g }
 Union in. at \$
 Meter in. at \$
 Lead Joints at \$
 Compound Joints at \$
 Maintenance Foreman \$
 Hrs. Water Maint. Man-1 at \$
 Hrs. Water Maint. Man-2 at \$
 Hrs. Garage Foreman at \$
 Hrs. Labor at \$
 Hrs. Compressor at \$
 Compensation Ins. at \$ per C \$
 Trucking \$
 Pav't Patch \$
 TAP MADE BY Beecher & Co \$
 O'head Feb-27-1976 \$

BROAD

St. No. 202

Name of Owner
 Den Wilhelm

Labor and Mat'l. Report Feb. 27 1976

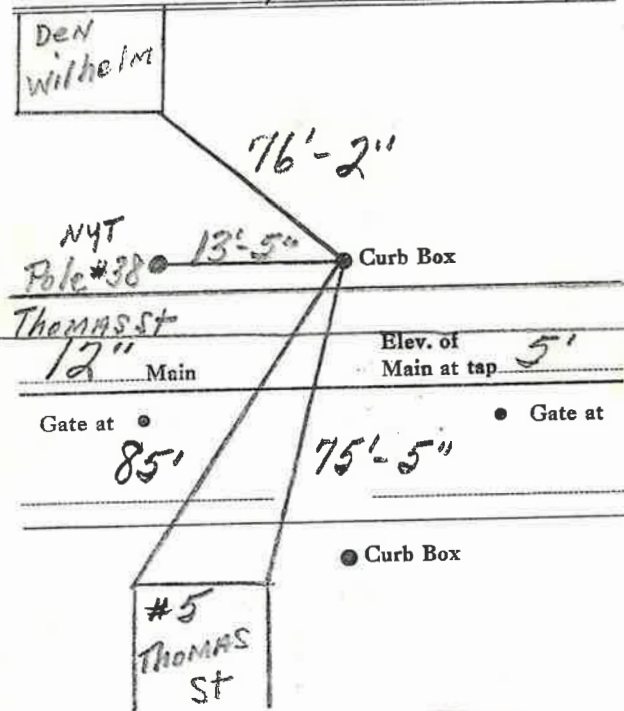

TAP ON THOMAS ST.

LSM-5C-6-1-67

32' 2" To main

LABOR AND MATERIALS

1	Copper	} Connection	1"	\$
	Lead			
1	Curb	} 1 in. <i>Oriseal</i>		\$
	Cock			
	Valve			
	T. S. & V.			
1	Service box	} { Short 3 1/2 x 4 1/2 Long 4 1/2 x 5 1/2 Buff or Rdway }		\$
	Old returned			
39	Ft. 1 in.	} { Copper G.I. C.I. }	Pipe at	\$
1	Nipples	1 in. at	<i>Male Adapter</i>	\$
	Bushings	to	in. at	\$
	Red'g	} Coupl'gs	to	in. at
	Inc'g			
1	Union	1 in. at	<i>3-Piece Coupling</i>	\$
	Meter	in. at		\$
	Lead Joints	at		\$
	Compound Joints	at		\$
	Maintenance Foreman			\$
	Hrs. Water Maint. Man	-1 at		\$
	Hrs. Water Maint. Man	-2 at		\$
	Hrs. Garage Foreman	at		\$
	Hrs. Labor	at		\$
	Hrs. Compressor	at		\$
	Compensation Ins.	at \$	per C	\$
	Trucking			\$
	Pay't Patch			\$
	<i>Tap Made by</i>			\$
	<i>Gifford</i>			\$
	O'head	<i>2-12-69</i>		\$

St. Broad
Pl. 202
Ave. No. 202

Name of Owner Deer Wilhem

Labor and Mat'l. Report Feb. 12 1969

● Curb Box

39' 1" to main
6" Main Elev. of Main at tap 5 1/2'

Gate at ● ● Gate at

● Curb Box

*By Driveway Ramp
Showroom Tap*

LABOR AND MATERIALS

_____ Copper } Connection _____ \$ _____
 _____ Lead }
 _____ Curb } Cock } _____ in. _____ \$ _____
 _____ Valve }
 _____ T.S. & V. }
 _____ Service box { Short 3-1/2 x 4-1/2 } _____ \$ _____
 _____ Old returned { Long 4-1/2 x 5-1/2 }
 _____ Ft. _____ in. { Copper } Pipe at _____ \$ _____
 _____ G.I.
 _____ C.I.
 _____ Nipples _____ in. at _____ \$ _____
 _____ Bushings _____ to _____ in. at _____ \$ _____
 _____ Red'g _____
 _____ Inc'g _____
 _____ Union _____ in. at _____ \$ _____
 _____ Meter _____ in. at _____ \$ _____
 _____ Compound Joints at _____ \$ _____
 _____ Maintenance Foreman _____ \$ _____
 _____ Hrs. Water Maint. Man - 1 at _____ \$ _____
 _____ Hrs. Water Maint. Man - 2 at _____ \$ _____
 _____ Hrs. Garage Foreman _____ at _____ \$ _____
 _____ Hrs. Labor _____ at _____ \$ _____
 _____ Hrs. Compressor at _____ \$ _____
 _____ Trucking _____ \$ _____
 _____ Pav't Patch _____ \$ _____
 _____ \$ _____
 _____ \$ _____
 _____ \$ _____
 _____ \$ _____
 _____ \$ _____

St. _____
 Pl. _____
 Ave. No. Broad Street 202

Name of Owner _____

Labor and Mat'l. Report 19 _____

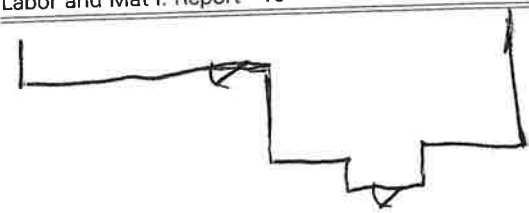

1 1/2"

● Curb Box ● Pole NW 43
 Elev. of _____
 Main ← 12" → Main at tap

Gate at ● ● Gate at

● Curb Box