

LABOR AND MATERIALS

1	Copper lead	Connection	3/4"	\$	2.71
1	Curb	Cock Valve T.S. & V.	3/4 in.	\$	3.83
1	Service box Old returned	Short 3 1/2 x 4 1/2 Long 4 1/2 x 5 1/2 Buff or Rdway		\$	4.69
37	Ft.	3/4 in. Copper C.I. C.I.	Pipe at 4.5	\$	16.65
	Nipples	in. at		\$	
	Bushings	to in. at		\$	
	Red'g Inc'g	Coupl'gs	to in. at	\$	
	Union	in. at		\$	
	Meter	in. at		\$	
	Lead Joints	at		\$	
	Compound Joints	at		\$	
1	Maintenance Foreman		1.51	\$	9.06
	Hrs. Water Maint. Man-1	at		\$	
8	Hrs. Water Maint. Man-2	at	1.24	\$	9.92
	Hrs. Garage Foreman	at		\$	
24	Hrs. Labor	at	1.13	\$	27.12
	Hrs. Compressor	at		\$	
	Compensation Ins.	at \$4.29 per C.		\$	1.95
	Trucking			\$	1.50
	Pav't Patch			\$	16.79
	Tap by Gifford & Co.			\$	
	June 27-55			\$	
	O'head			\$	
				\$	93.67

Broad St. Pl. Ave. No. 90

Name of Owner
Garden

Labor and Mat'l. Report June 7 1955

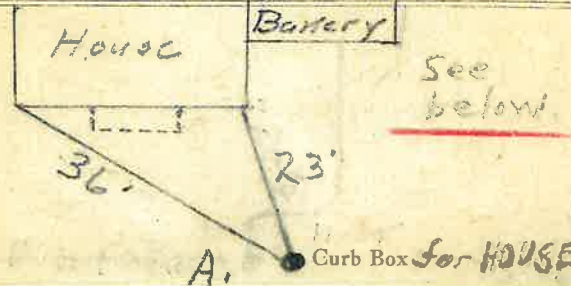

6" Main Elev. of Main at tap 5'

Gate at House A, Gate at Bakery B, Bath House and Bakery C.

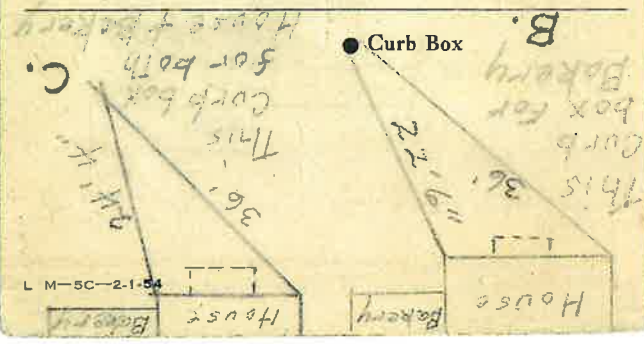

L M-5C-2-1-54

St. Broad
Pl. No. 90

Name of Owner

Garden

Labor and Mat'l. Report
June 7 1953

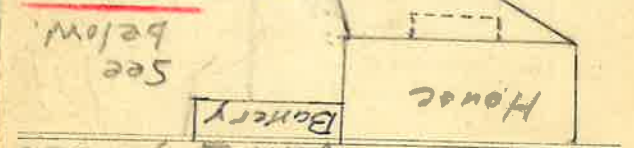

Elev. of Main at tap 5'

Gate at House A.

Gate at B. Bakery

Both Houses + Bakery C.

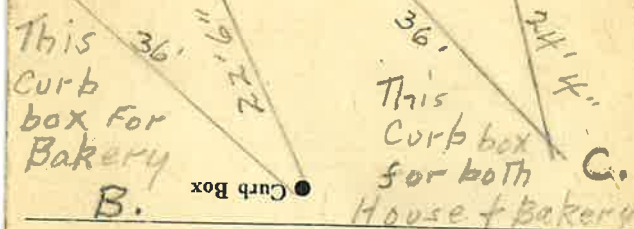

House Bakery House Bakery
L M-5C-2-1-54