

LABOR AND MATERIALS

1	Copper Lead	Connection	3/4"	\$
1	Curb	Cock Valve T-S. & V.	3/4 in. or seal	\$
1	Service box	Short 3 1/2 x 4 1/2		
	Old returned	Long 4 1/2 x 5 1/2		
		Buff. or Rdway		\$
11	Ft. 3/4 in.	Copper Pipe at		\$
		G. I.		
		C. I.		
	Nipples	in. at		\$
	Bushings	to in. at		\$
	Red'g Inc'g	Coupl'gs to in. at		\$
	Union	in. at		\$
	Meter	in. at		\$
	Lead Joints at			\$
	Compound Joints at			\$
	Maintenance Foreman			\$
	Hrs. Water Maint. Man-1 at			\$
	Hrs. Water Maint. Man-2 at			\$
	Hrs. Garage Foreman at			\$
	Hrs. Labor at			\$
	Hrs. Compressor at			\$
	Compensation Ins. at \$	per C		\$
	Trucking			\$
	Pav't Patch			\$
	Tap by Gifford & Co.			\$
	4-16-63.			\$
	O'head			\$

St. 91-91A.
Pl. Ave. No.

Broad
Name of Owner Shapiro

Labor and Mat'l. Report April 16 1963.

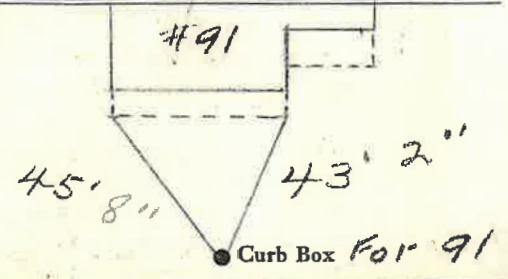

6" C.I. Main Elev. of Main at tap 5'

Gate at • TAX ID # 309.35-1-6 • Gate at

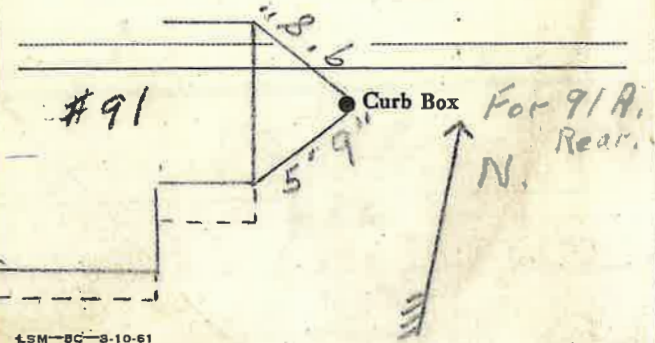

LSM-8C-8-10-61

2 Houses on 1 Tap.