

LABOR AND MATERIALS

1	Copper Lead	Connection	3/4"	\$
1	Curb	Cock Valve P.S. & V.	3/4" in. (MARK II ORISEAL)	\$
1	Service box	Short 3 1/2 x 4 1/2		\$
	Old returned	Long 4 1/2 x 5 1/2		\$
		Buff or Rdway.		\$
22	Ft. 3/4 in.	Copper Pipe at		\$
	Nipples	in. at		\$
	Bushings	to in. at		\$
	Red'g			\$
	Inc'g	Coupl'gs. to in. at		\$
	Union	in. at		\$
	Meter	in. at		\$
	Lead Joints	at		\$
	Compound Joints	at		\$
	Maintenance Foreman			\$
	Hrs. Water Maint. Man-1	at		\$
	Hrs. Water Maint. Man-2	at		\$
	Hrs. Garage Foreman	at		\$
	Hrs. Labor	at		\$
	Hrs. Compressor	at		\$
	Compensation Ins. at \$	per C		\$
	Trucking			\$
	Pav't Patch			\$
	TAP MADE BY PECK & CO			\$400
	8-23-1972			\$
	O'head			\$

BROAD

St. Ave. No. 101

Name of Owner

K. KNOWLTON

Labor and Mat'l. Report

AUG 23 1972

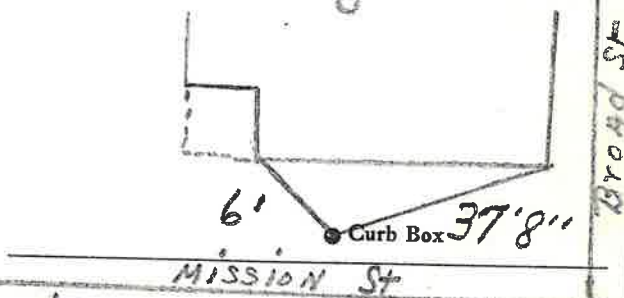

10" Main

Elev. of Main at tap 5'

Gate at ●

● Gate at

TAP ON MISSION ST

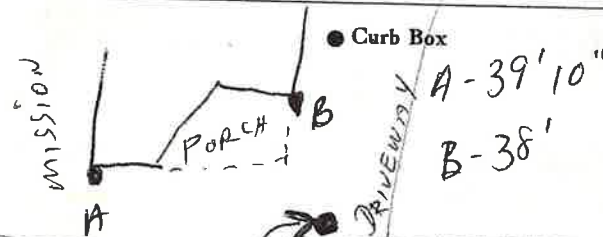

LSM-5C-6-1-67

BROAD OUTSIDE CLEAN-OUT