

LABOR AND MATERIALS

Copper	}	Connection	-----	\$
Lead				
Curb	{	Cock Valve	in.	\$
		T. S. & V.		
Service Box	}	Short 3 1/2 x 4 1/2	}	\$
Old returned		Long 4 1/2 x 5 1/2		
		Buff. or Rdway		
Ft.	}	Copper	} Pipe at	\$
in.		Galv Iron		
		Cast Iron		
Nipples		in. at	\$	
Bushings		to in. at	\$	
Red'g Inc'g	}	Couplings	to in. at	\$
Union		in. at	\$	
Meter		in. at	\$	
Lead Joints		at	\$	
Leadite Joints		at	\$	
Hrs. Foreman		at	\$	
Hrs. Chauffeur		at	\$	
Hrs. Tapper		at	\$	
Hrs. Labor		at	\$	
Hrs. Labor		at	\$	
Hrs. Compressor		at	\$	
Compensation Ins.			\$	
Trucking			\$	
Builders Use of Water			\$	
			\$	
			\$	
			\$	
			\$	
			\$	

St. ¹¹¹⁹
 Pl. ¹¹¹⁹
 Ave. No. ⁹⁷

Broad

Name of Owner
Bertovitz

Labor and Mat'l. Report 7-31-39 19

#99
119-A-B-C-D

This House burned March 1953 and was razed.

● Curb Box

Main	Elev. of Main at tap
Gate at ●	● Gate at

● Curb Box

old Measurements
 For # 119 Broad St.

LABOR AND MATERIALS

1	Copper Lead	Connection	3/4"		\$ 3.20
1	Curb	Cock Valve T. S. & V.	3/4 in.		\$ 1.00
1	Service box Old returned	Short 3 1/2 x 4 1/2 Long 4 1/2 x 5 1/2 Buff or Rdway			\$ 1.30
10	Ft.	3/4 in. Copper G.I. C.I.	Pipe at		\$ 2.20
	Nipples	in. at			\$
	Bushings	to in. at			\$
	Red'g				\$
	Inc'g	Coupl'gs to in. at			\$
	Union	in. at			\$
	Meter	in. at			\$
	Lead Joints	at			\$
	Compound Joints	at			\$
	Maintenance Foreman				\$
	Hrs. Water Maint. Man	1 at			\$
	Hrs. Water Maint. Man	2 at			\$
5	Hrs. Garage Foreman	at	62.5		\$ 3.12
19	Hrs. Labor	at	50		\$ 9.50
	Hrs. Compressor	at			\$
	Compensation Ins.	at \$		per C	\$ 1.33
	Trucking				\$ 1.00
	Pav't Patch				\$
	O'head				\$
					\$21.65

26-105

Broad

St. 121

Pl. 99

Ave. No. 99

Name of Owner Berkowitz

Labor and Mat'l. Report Aug 14 19 26

RAZED

Changed over 7-30-57

6" Main

Gate at ●

Elev. of
Main at tap 6'

● Gate at

● Curb Box

This Tap once Fed
121 Broad St, old #99.
Now being used by
#119 Broad St.
old Tap for #119
Dug up & disconnected.

LSM-5C-2-5 56

Labor and Materials

1	Copper	Head	Connection	3/4"	\$ 3.20
1	Curb	Cock Valve	T.S. & V.	3" in.	\$ 1.00
1	Service Box	Short	3 1/2 x 4 1/2		\$ 1.30
	Old returned	Long	3 1/2 x 5 1/2		
			Buff. or Rdway		
10	Ft.	in.	Copper Galv. Iron	Pipe at	\$ 2.20
			Cast Iron		
	Nipples	in.	at		\$
	Bushings	to	in. at		\$
	Red'g Inc'g	Couplings	to	in. at	\$
	Union	in.	at		\$
	Meter	in.	at		\$
	Lbs. Br. Stone	at			\$
	Lbs. Sand	at			\$
	Bags Cement	at			\$
	Paving Brick	Mack Red Asphalt	at		\$
	Lead Joints	at			\$
	Leadite Joints	at			\$
5	Hrs. Foreman	at	62.5		\$ 3.12
19	Hrs. Common Labor	at	50		\$ 9.50
	Hrs. Common Labor	at			\$
	Hrs. Mason	at			\$
	Hrs. Mason's Helper	at			\$
	Hrs. Compressor	at			\$
	Compensation Ins.				\$ 33
	Trucking				\$ 1.00
	Builders' Use of Water				\$
Total					\$ 21.65

76-107^{old}
121 A B 119

Labor and Material Report 19

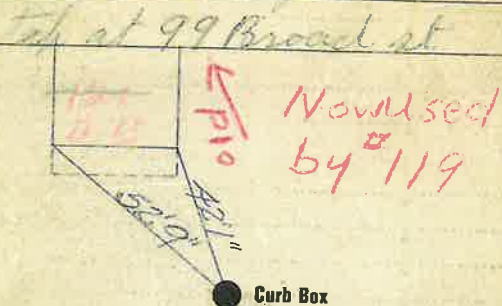

Main

Elev. of Main at tap

Gate at

Gate at

Curb Box

This House burned March-1953 and was Razed.

This Tap shut off at Curb + Curb box dug up & taken out. Curb stop under concrete Near Curb box for #119 or old #97