

Labor and Materials

Lead Connection	3/4"	\$
Curb Cock	1 1/2"	\$
Service Box	(Short 9" x 4")	\$
Old returned	(Long 4 1/2" x 5 1/2") Buffalo	\$
Ft. in. G. I. Pipe at		\$
Nipples	in. at	\$
Bushings	in. at	\$
Red'g Coup	to in. at	\$
Inc'g Coup	to in. at	\$
Union	in. at	\$
Meter	in. at	\$
Cu. Yds. Br. Stone at		\$
Cu. Yds. Sand at		\$
Bags Cement at		\$
Pav. Brick	(Mack Red Asphalt) at	\$
2 Hrs. Foreman at		\$
Hrs. Com. Labor at		\$
Hrs. Mason at		\$
2 Hrs. <i>Plumb</i> at		\$
Hrs. at		\$
Builders' Use of Water		\$
Trucks	at	\$
	at	\$
	at	\$
	at	\$
	at	\$

Labor and Material Report

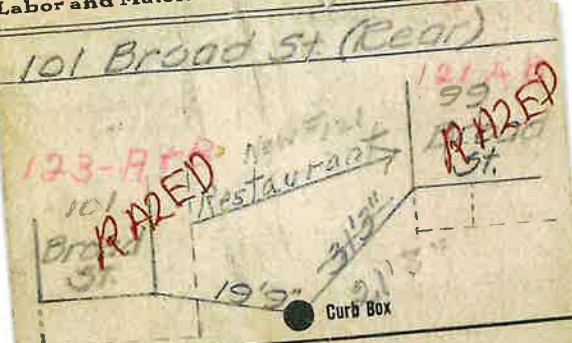

Main Elev. of Main at tap
 Gate at ● ● Gate at
 Curb Box ●

16 12/14