

LABOR AND MATERIALS

1	Copper Lead	}	Connection <u>3/4"</u>		\$
1	Curb	}	Cock Valve T. S. & V.	in.	\$
	Service box Old returned	{	Short $3\frac{1}{2} \times 4\frac{1}{2}$ Long $4\frac{1}{2} \times 5\frac{1}{2}$ Buff or Rdway		\$
13	Ft. 6 in.	{	Copper G.I. G.I.	Pipe at	\$
	Nipples		in.	at	\$
	Bushings		to	in. at	\$
	Red'g Inc'g	}	Coupl'gs	to in. at	\$
	Union		in.	at	\$
	Meter		in.	at	\$
	Lead Joints		at		\$
	Compound Joints		at		\$
	Maintenance Foreman				\$
	Hrs. Water Maint. Man-1		at		\$
	Hrs. Water Maint. Man-2		at		\$
	Hrs. Garage Foreman		at		\$
	Hrs. Labor		at		\$
	Hrs. Compressor		at		\$
	Compensation Ins.		at \$	per C	\$
	Trucking				\$
	Pav't Patch				\$
					\$
					\$
	O'head				\$
					\$

BROAD

St.
Pt.
Ave. No. 123

Name of Owner

Gordon Roth

Labor and Mat'l. Report Dec 17 1976

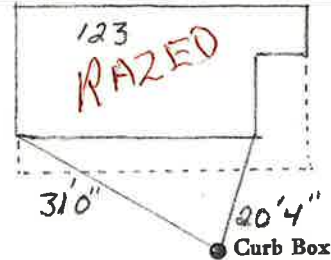

6" Main

Elev. of
Main at tap

Gate at ●

● Gate at

● Curb Box