

LABOR AND MATERIALS

1	Copper	Connection	3/4"	\$
	Lead			
1	Curb	Cock Valve	3/4 in.	\$
		T. S. & V.		
1	Service box	Short 3 1/2 x 4 1/2		\$
	Old returned	Long 4 1/2 x 5 1/2		
		Buff or Rdway		
15	Ft. 3/4 in.	Copper	Pipe at	\$
		G.I.		
		G.I.		
	Nipples	in. at		\$
	Bushings	to in. at		\$
	Red'g			
	Inc'g	Coupl'gs to in. at		\$
	Union	in. at		\$
	Meter	in. at		\$
	Lead Joints at			\$
	Compound Joints at			\$
	Maintenance Foreman			\$
	Hrs. Water Maint. Man-1 at			\$
	Hrs. Water Maint. Man-2 at			\$
	Hrs. Garage Foreman at			\$
	Hrs. Labor at			\$
	Hrs. Compressor at			\$
	Compensation Ins. at \$	per C		\$
	Trucking			\$
	Pav't Patch			\$
	Tap by Gissard & Co.			\$
		6-11-13-56		\$
	O'head			\$

Carleton Court St. Pl. Ave. No. 10

Name of Owner

Labor and Mat'l. Report June 11-13 19 56

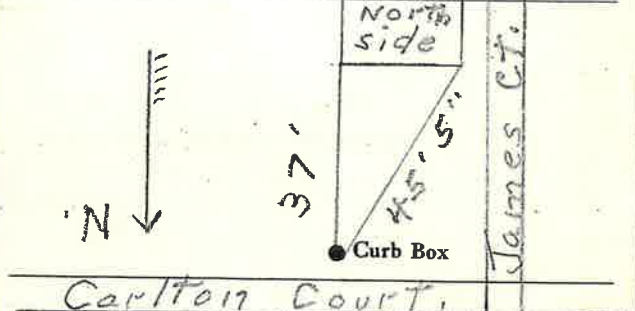

Carleton Court, Elev. of Main at tap 5708'

6 Main Gate at • Gate at

This Tap on Carleton Ct. Measured from North Side of House