

LABOR AND MATERIALS

1	Copper	} Connection $\frac{3}{4}$ "	\$
	Lead		
1	Curb	} $\frac{3}{4}$ in.	\$
	Cock		
	Valve		
		T. S. & V.	\$
1	Service box	{ Short $3\frac{1}{2}$ x $4\frac{1}{2}$ Long $4\frac{1}{2}$ x $5\frac{1}{2}$ Buff or Rdway }	\$
25	Old returned		
15	Ft. $\frac{3}{4}$ in.	{ Copper G. I. C. I. }	Pipe at \$
	Nipples		in. at \$
	Bushings		to in. at \$
	Red'g	} Coupl'gs. to in. at \$	
	Inc'g		
	Union	in. at \$	
	Meter	in. at \$	
	Lead Joints	at \$	
	Compound Joints	at \$	
	Maintenance Foreman	\$	
	Hrs. Water Maint. Man-1	at \$	
	Hrs. Water Maint. Man-2	at \$	
	Hrs. Garage Foreman	at \$	
	Hrs. Labor	at \$	
	Hrs. Compressor	at \$	
	Compensation Ins.	at \$ per C \$	
	Trucking	\$	
	Pav't Patch	\$	
	Tap by G. S. Ford	\$	
		\$	
		\$	
	O'head	\$	
		\$	

Ronald Clear

ct.

St.

Pl.

Ave. No. 3

Name of Owner

Labor and Mat'l. Report June 11/13 1956

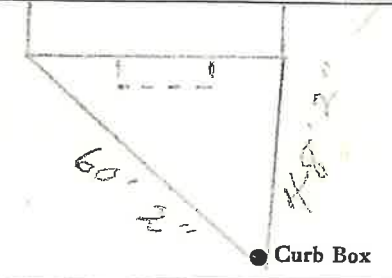

6" Main

Elev. of Main at tap 5.08'

Gate at ●

● Gate at

● Curb Box