

LABOR AND MATERIALS

1	Copper Lead	Connection	3/4"	\$
1	Curb	Cock Valve T.S. & V.	3/4 in.	\$
1	Service box	{ Short 3 1/2 x 4 1/2 Long 4 1/2 x 5 1/2 Buff or Rdway }		\$
	Old returned			
15	Ft.	{ Copper G.I. C.I. }	3/4 in. Pipe at	\$
	Nipples	in. at		\$
	Bushings	to in. at		\$
	Red'g Inc'g	Coupl'gs	to in. at	\$
	Union	in. at		\$
	Meter	in. at		\$
	Lead Joints	at		\$
	Compound Joints	at		\$
	Maintenance Foreman			\$
	Hrs. Water Maint. Man	1 at		\$
	Hrs. Water Maint. Man	2 at		\$
	Hrs. Garage Foreman	at		\$
	Hrs. Labor	at		\$
	Hrs. Compressor	at		\$
	Compensation Ins.	at \$ per C		\$
	Trucking			\$
	Pav't Patch			\$
	Tap by Giggard & Co			\$
	6 - 11/13-56			\$
	O'head			\$
				\$

Carleton ct.
St.
Pl.
Ave. No. 4

Name of Owner
Vito C. Isoro

Labor and Mat'l. Report June 11/13 1956

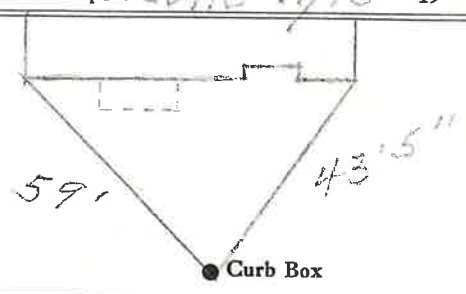

6" Main Elev. of Main at tap 5-8'

Gate at • • Gate at

• Curb Box

New House 1962.

LABOR AND MATERIALS

1	Copper Lead	Connection	$\frac{3}{4}$ "	\$	_____
1	Curb	Cock Valve T. S. & V.	$\frac{3}{4}$ in.	\$	_____
1	Service box Old returned	Short $3\frac{1}{2} \times 4\frac{1}{2}$ Long $4\frac{1}{2} \times 5\frac{1}{2}$ Buff or Rdway		\$	_____
15	Ft. $\frac{3}{4}$ in.	Copper C.I. C.I.	Pipe at	\$	_____
	Nipples	in. at		\$	_____
	Bushings	to in. at		\$	_____
	Red'g Inc'g	Coupl'gs. to in. at		\$	_____
	Union	in. at		\$	_____
	Meter	in. at		\$	_____
	Lead Joints	at		\$	_____
	Compound Joints	at		\$	_____
	Maintenance Foreman			\$	_____
	Hrs. Water Maint. Man-1	at		\$	_____
	Hrs. Water Maint. Man-2	at		\$	_____
	Hrs. Garage Foreman	at		\$	_____
	Hrs. Labor	at		\$	_____
	Hrs. Compressor	at		\$	_____
	Compensation Ins. at \$	per C		\$	_____
	Trucking			\$	_____
	Pav't Patch			\$	_____
	Tap by Gifford & Co.			\$	_____
				\$	_____
				\$	_____
	O'head			\$	_____
				\$	_____

Tap by Gifford & Co.
#6-11/13-56

✓ Lot Tap

Carlton Court -St.
-Pl- Ave. No. 4

Name of Owner _____

Labor and Mat'l. Report June 11+13 1956

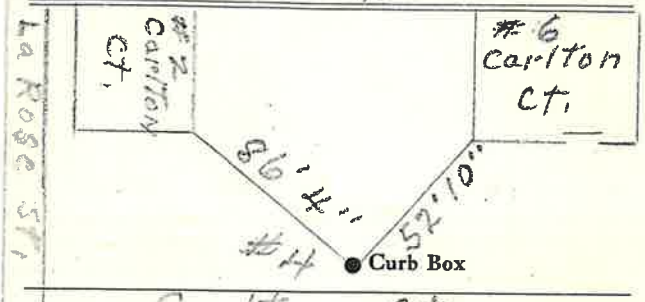

Carlton Ct.
6 Main Elev. of Main at tap 5 to 8'

Gate at • • Gate at

• Curb Box