

### LABOR AND MATERIALS

1 Copper Lead	Connection	3/4	\$ 2.94
1 Curb	Clock Valve	3/4 in.	\$ 3.71
1 Service box	Old returned	Short 3" X 4" Long 4" X 5" Buff or Rdway	\$ 5.90
18 Ft. 3/4 in.	Copper Galv. Iron Cast Iron	Pipe at 30	\$ 5.40
	Nipples	in. at	\$
	Bushings	to in. at	\$
	Red'g Inc'g	Couplings to in. at	\$
	Union	in. at	\$
	Meter	in. at	\$
	Lead Joints	at	\$
	Compound Joints	at	\$
	Hrs. Foreman	at	\$
5	Hrs. Chauffeur	WMM. 2 - 91	\$ 4.55
	Hrs. Tapper	at	\$
14	Hrs. Labor	at 80	\$ 11.20
	Hrs. Labor	at	\$
	Hrs. Compressor	at 1.20	\$ 1.20
	Compensation Ins.		\$ 35
	Trucking		\$ 1.00
	Builders Use of Water	Patch	\$ 8.00
	<i>lapy Mignion</i>		\$
			\$
			\$
			\$
			\$
			\$
			\$
			\$
			\$
			\$
			\$
			\$
			\$
			\$ 44.25

St.  
Pl.  
Ave. No. 1

*Charlotte*

Name of Owner

*Butler*

Labor and Mat'l. Report

*May 6*

19

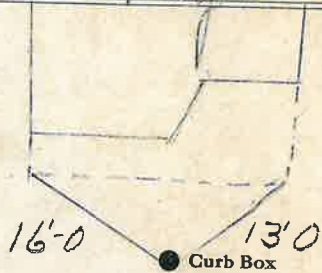

4

Main

Elev. of  
Main at tap 6

Gate at ●

● Gate at

● Curb Box