

St. _____
 Pl. _____
 Ave. No. 46

Name of Owner

Clarence Kappeth

Labor and Mat'l. Report

Nov. 1 1967

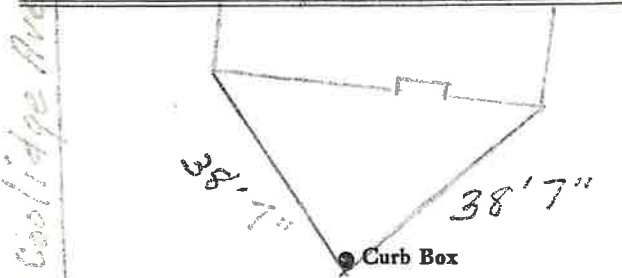

Kensington Rd.

16" Main

Elev. of Main at tap 5 1/2'

Gate at ●

● Gate at

M.H.

● Curb Box

CORP STOP.

Tap on Kensington Rd.

LSM-5C-6-1-67

LABOR AND MATERIALS

1	Copper Lead	Connection	<u>3/4"</u>	\$
1	Curb	Cock Valve	<u>3/4" in.</u>	\$
1	Service box	T.S. & V. {	Short <u>3 1/2 x 4 1/2</u> Long <u>4 1/2 x 5 1/2</u> Buff or Rdway	\$
	Old returned			\$
26	<u>3/4</u> in.	Copper	Pipe at	\$
		C.I.		\$
		C.I.		\$
	Nipples	in. at		\$
	Bushings	to in. at		\$
	Red'g Inc'g	Coupl'gs to in. at		\$
	Union	in. at		\$
	Meter	in. at		\$
	Lead Joints at			\$
	Compound Joints at			\$
	Maintenance Foreman			\$
	Hrs. Water Maint. Man-1 at			\$
	Hrs. Water Maint. Man-2 at			\$
	Hrs. Garage Foreman at			\$
	Hrs. Labor— at			\$
	Hrs. Compressor at			\$
	Compensation Ins. at \$		per C	\$
	Trucking			\$
	Pav't Patch			\$
	Tap by Gifford & Co.			\$
	O'head	<u>11-1-67.</u>		\$

9H