

9 8 - 1938

~~St.~~
~~Pl.~~
Coolidge Ave. No. 59

Name of Owner
Pratt

Labor and Mat'l. Report Aug 23 1938

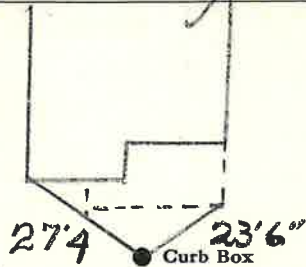

6 Main Elev. of Main at tap 4 1/2
Gate at ● Gate at ●

● Curb Box

PA

old shut off

Gate at
1 1/2

23 19 38

No. 57

LABOR AND MATERIALS

1	Copper Lead	Connection	$\frac{3}{4}$	\$	1.23
1	Curb	Cock Valve T-S & V.	$\frac{3}{4}$ in.	\$	1.68
1	Service Box Old returned	Short $3\frac{1}{2} \times 4\frac{1}{2}$ Long $4\frac{1}{2} \times 5\frac{1}{2}$ Buff. or Rdway		\$	1.75
35	Ft.	$\frac{3}{4}$ in. Copper Galv. Iron Cast Iron	Pipe at	\$	5.25
	Nipples	in. at		\$	
	Bushings	to in. at		\$	
	Red'g Inc'g	Couplings to in. at		\$	
	Union	in. at		\$	
	Meter	in. at		\$	
	Lead Joints at			\$	
	Leadite Joints at			\$	
	Hrs. Foreman at			\$	
5	Hrs. Chauffeur at	$6\frac{1}{2}$		\$	3.13
2	Hrs. Tapper at	$\frac{7}{8}$		\$	1.25
11	Hrs. Labor at	$\frac{4}{5}$		\$	4.95
	Hrs. Labor at			\$	
	Hrs. Compressor at			\$	
	Compensation Ins.			\$.29
	Trucking			\$	1.00
	Builders Use of Water	patch (B.P.)		\$	
	<i>Tupley Hessel</i>			\$	
	<i>TU</i>			\$	
				\$	20.53

65