

LABOR AND MATERIALS

1	Copper Lead	Connection	3/4"	\$
1	Curb	Cock Valve T.S. & V.	3/4 in.	\$
same	Service box Old returned	Short 3 1/2 x 4 1/2 Long 4 1/2 x 5 1/2 Buff or Rdway		\$
32	Ft.	3/4 in. Copper G.I. G.I.	Pipe at	\$
1	Nipples	2 in. at	Brass	\$
	Bushings	to in. at		\$
1	Red'g Inch	Coupl'gs	1" to 3/4 in. at	Brass \$
	Union	in. at		\$
	Meter	in. at		\$
	Lead Joints	at		\$
	Compound Joints	at		\$
	Maintenance Foreman			\$
	Hrs. Water Maint. Man	1 at		\$
	Hrs. Water Maint. Man	2 at		\$
	Hrs. Garage Foreman	at		\$
	Hrs. Labor	at		\$
	Hrs. Compressor	at		\$
	Compensation Ins.	at \$ per C		\$
	Trucking			\$
	Pav't Patch			\$
	Tap by	Gissard, Miller & Co.		\$
		12-20-56		\$
	O'head			\$
				\$

6

Coolidge -St.  
-Pt.  
Ave. No. 6

Name of Owner Cushman

Labor and Mat'l. Report Dec. 20 1956

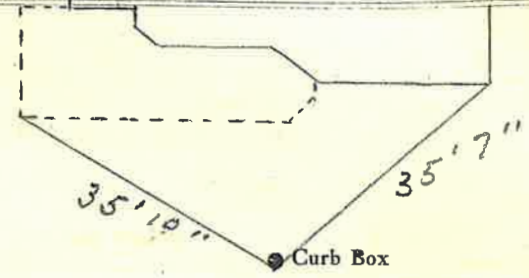

6" Main Elev. of  
Main at tap 5 1/2'

Gate at • • Gate at

TAX ID # 302.15-12-8

• Curb Box