

LABOR AND MATERIALS

Copper	} Connection	_____	\$
Lead		_____	\$
Curb	} Cock Valve T.S. & V. }	_____ in.	\$
		_____	\$
Service box	} Short 3½ x 4½ } Long 4½ x 5½ }	_____	\$
Old returned		_____	\$
14 Ft. ¾ in.	} Copper G.I. } C.I.	Pipe at _____	\$
		_____	\$
Nipples	_____ in. at _____	\$	
Bushings	_____ to _____ in. at _____	\$	
Red'g Inc'g	} Coupl'gs _____ to _____ in. at _____	\$	
Union		_____ in. at _____	\$
Meter	_____ in. at _____	\$	
	_____	\$	
Compound Joints	at _____	\$	
Maintenance Foreman	_____	\$	
Hrs. Water Maint. Man—1	at _____	\$	
Hrs. Water Maint. Man—2	at _____	\$	
Hrs. Garage Foreman	at _____	\$	
Hrs. Labor—	at _____	\$	
Hrs. Compressor	at _____	\$	
	_____	\$	
Trucking	_____	\$	
Pav't Patch	_____	\$	
	_____	\$	
	_____	\$	
	_____	\$	
	_____	\$	
	_____	\$	
	_____	\$	

COTTAGE St. Pl. Ave. No. 4

Name of Owner _____

Labor and Mat'l. Report 19 77

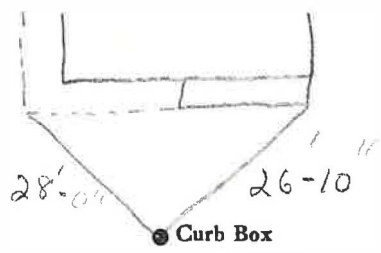

6" Main (1974) Elev. of Main at tap 5'-1"

Gate at • • Gate at

• Curb Box

LSM-5C-6.1-67

28" 0"