

LABOR AND MATERIALS

1 Copper } Connection 3/4" \$
 lead }
 1 Curb } Cock } 3/4 in. *ORISEAL*
 Valve } *MARNS II*
 P.S. & V. }
 1 Service box { Short 3 1/2 x 4 1/2 }
 Old returned { Long 4 1/2 x 5 1/2 }
 { Buff or Rdway. } \$
 10 Ft. 3/4 in. { Copper } Pipe at \$
 { C.I. }
 { C.I. }
 Nipples in. at \$
 Bushings to in. at \$
 Red'g }
 Inc'g } Coupl'gs to in. at \$
 Union in. at \$
 Meter in. at \$
 Lead Joints at \$
 Compound Joints at \$
 Maintenance Foreman \$
 Hrs. Water Maint. Man-1 at \$
 Hrs. Water Maint. Man-2 at \$
 Hrs. Garage Foreman at \$
 Hrs. Labor at \$
 Hrs. Compressor at \$
 Compensation Ins. at \$ per C \$
 Trucking \$
 Pav't Patch \$
 TAP MADE BY DECK & CO
 APR 11-14-1972 \$
 \$
 \$
 O'head \$
 \$

CRANDALL St.
 Ave. No. 35

Name of Owner
 H. B. SEAMAN

Labor and Mat'l. Report April-14 1972

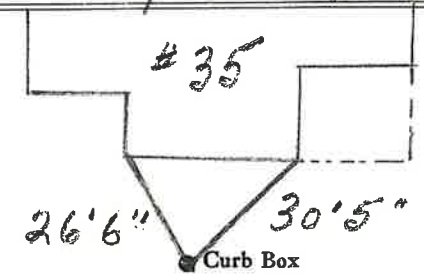

10" Main Elev. of Main at tap 5 1/2"

Gate at • Gate at

• Curb Box