

LABOR AND MATERIALS

1	Copper	} Connection $\frac{3}{4}$ "	\$
	Lead		
1	Curb	} Cock Valve T.S. & V. } 1" in.	\$
1	Service box	} Short $3\frac{1}{2}$ x $4\frac{1}{2}$ Long $4\frac{1}{2}$ x $5\frac{1}{2}$ }	\$
	Old returned		
16	Ft. 1" in.	} Copper G. I. C.I.	Pipe at \$
	Nipples	in. at	\$
	Bushings	1" to $\frac{1}{2}$ " in. at	\$
	Red'g	} Coupl'gs to in. at	\$
	Inc'g		
	Union	in. at	\$
	Meter	in. at	\$
			\$
	Compound Joints		\$
	Maintenance Foreman		\$
	Hrs. Water Maint. Man-1	at	\$
	Hrs. Water Maint. Man-2	at	\$
	Hrs. Garage Foreman	at	\$
	Hrs. Labor	at	\$
	Hrs. Compressor	at	\$
			\$
	Trucking		\$
	Pav't Patch		\$
			\$
			\$
			\$
			\$
			\$

St. CRANDALL
~~Pl.~~
 Ave. No. 62

Name of Owner
 TAX ID # 302.19-25-2

Labor and Mat'l. Report SEPT 20 1924

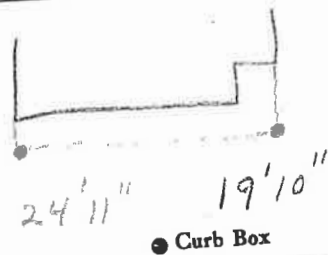

10" Main
 Gate at ● Elev. of Main at tap 4 1/2'
 Gate at ● Gate at ●
 ● Curb Box