

LABOR AND MATERIALS

1	Copper Lead	} Connection	$\frac{3}{4}$	in.	\$	
1	Curb					} Cock Valve T.S. & V.
1	Service box Old returned	{ Short $3\frac{1}{2} \times 4\frac{1}{2}$ Long $4\frac{1}{2} \times 5\frac{1}{2}$				
23	Ft. $\frac{3}{4}$ in.		} Copper C.P. C.P.	} Pipe at		\$
	Nipples	in. at		\$		
	Bushings	to in. at		\$		
1	Red'g Ine'g	} Coupl'gs	$\frac{3}{4}$	to in. at	\$	
	Union					in. at
	Meter	in. at		\$		
	Compound Joints	at		\$		
	Maintenance Foreman			\$		
	Hrs. Water Maint. Man—1	at		\$		
	Hrs. Water Maint. Man—2	at		\$		
	Hrs. Garage Foreman	at		\$		
	Hrs. Labor—	at		\$		
	Hrs. Compressor	at		\$		
	Trucking			\$		
	Pav't Patch			\$		
				\$		
				\$		
				\$		
				\$		

St. ~~Pl.~~ No. 78
CRANDALL
 Name of Owner
 TAX ID # 302.19-19-3

Labor and Mat'l. Report JUNE 18 1927

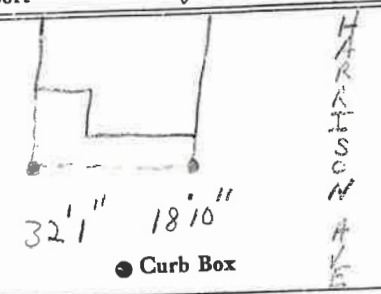

CRANDALL ST.
 10" Main Elev. of Main at tap 4'
 Gate at • Gate at

• Curb Box

OLD TAP SHUT OFF