

LABOR AND MATERIALS

1	Copper Lead	Connection	3/4"	\$
1	Curb	Cock Valve T. S. & V.	3/4" in.	\$
1	Service Box Old returned	Short 3 1/2 x 4 1/2 Long 4 1/2 x 5 1/2 Buff. or Rdway		\$
6	Ft.	3/4 in.	Copper Galv Iron Cast Iron	Pipe at \$
	Nipples	in. at		\$
	Bushings	to in. at		\$
	Red'g Inc'g	Couplings to in. at		\$
	Union	in. at		\$
	Meter	in. at		\$
	Lead Joints	at		\$
	Leadite Joints	at		\$
	Hrs. Foreman	at		\$
	Hrs. Chauffeur	at		\$
	Hrs. Tapper	at		\$
	Hrs. Labor	at		\$
	Hrs. Labor	at		\$
	Hrs. Compressor	at		\$
	Compensation Ins.			\$
	Trucking			\$
	Builders Use of Water			\$
				\$
				\$
				\$
				\$
				\$

St. ~~Ph~~
 Ave. No. 118

Grandall

Name of Owner

Labor and Mat'l. Report

1927

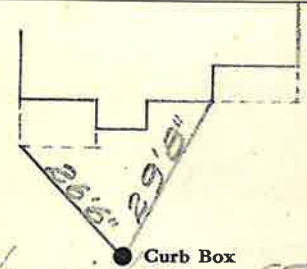

Tap on Sheridan St.

6" Main Sheridan Elev. of Main at tap 4'

Gate at ● St. ● Gate at

● Curb Box