

Labor and Materials

Copper } Connection.....		\$ 320
Lead }		
Curb } Cock Valve }	in.	\$ 100
	T. S. & V. }	
Service Box } Short 3 1/2 x 4 1/2 }		\$ 130
Old returned } Long 4 1/2 x 5 1/2 }		
	Buff. or Rdway }	
15 Ft. 2 1/2 in. } Copper } Pipe at.....		\$ 330
	Galv. Iron }	
	Cast-Iron }	
Nipples.....	in. at.....	\$
Bushings.....	to..... in. at.....	\$ 08
Red'g } Couplings.....	to..... in. at.....	\$
Inc'g }		
Union.....	in. at.....	\$
Meter.....	in. at.....	\$
Lbs. Br. Stone at.....		\$
Lbs. Sand at.....		\$
Bags Cement at.....		\$
Paving Brick } Mack } at.....		\$
	Red }	
	Asphalt }	
Lead Joints at.....		\$
Leadite Joints at.....		\$
10 Hrs. Foreman at.....	6.25	\$ 6.25
10 Hrs. Common Labor at.....	50	\$ 5.00
6 Hrs. Common Labor at.....	37 1/2	\$ 2.25
Hrs. Mason at.....		\$
Hrs. Mason's Helper at.....		\$
Hrs. Compressor at.....		\$
Compensation Ins.....		\$ 27
Trucking.....		\$ 1.00
Builders' Use of Water.....		\$
Total \$		23.94

26-177

8

Labor and Material Report

19

Measurement for 4 Culvert

Hosehouse Basin

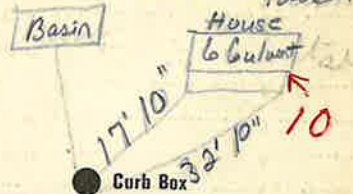

Main

Elev. of
Main at tap

Gate at

Gate at

Curb Box

Measured from
6 Culvert st.
10

Amount of man
→