

### LABOR AND MATERIALS

1	Copper	{ Connection	3/4		\$ 2.87
1	Lead				
1	Curb	{ Cock Valve	3/4 in.		\$ 3.62
		{ T.S. & V.			
1	Service box	{ Short 3 1/2 x 4 1/2			4.68
	Old returned	{ Long 4 1/2 x 5 1/2			
		{ Buff or Rdway			
27	Ft. 3/4 in.	{ Copper			8.64
		{ C.I.			
		{ C.I.	Pipe at 32		
	Nipples	in. at			\$
	Bushings	to in. at			\$
	Red'g Inc'g	{ Coupl'gs to in. at			\$
	Union	in. at			\$
	Meter	in. at			\$
	Lead Joints	at			\$
	Compound Joints	at			\$
	Hrs. Water Maint. Man-1	at			\$
7	Hrs. Water Maint. Man-2	at 1.02			\$ 7.14
14	Hrs. Labor	at 91			\$ 12.74
	Hrs. Labor	at			\$
2	Hrs. Compressor	at 1.20			\$ 2.40
	Compensation Ins. at \$2.18	per C.			\$ 43
	Trucking				\$ 2.00
	Pav't Patch				\$ 10.25
	<i>Tap by Marsinsler</i>				\$
					\$
					\$
	O'head				\$
					\$ 54.77

131

St 31  
Pl 23  
Ave. No. 23

Cunningham

Name of Owner

Nisshoff

Labor and Mat'l. Report

Nov 30 1909

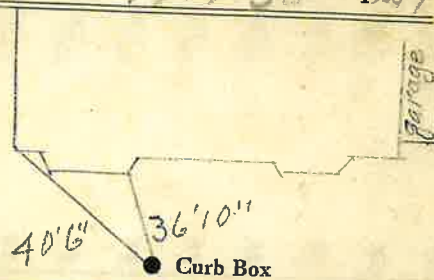

6 Main

Elev. of Main at tap

Gate at ●

● Gate at

● Curb Box